

SOUTHCENTRAL FOUNDATION  
**PCC FIRE ALARM STROBE LIGHT UPGRADES**  
4320 DIPLOMACY DRIVE ANCHORAGE, AK 99508

BID DOCUMENTS  
07.11.2023

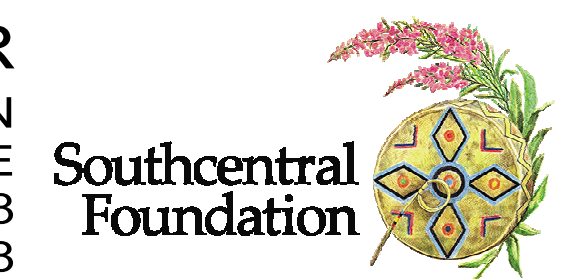

**OWNER**  
SOUTHCENTRAL FOUNDATION  
4510 DIPLOMACY DRIVE  
ANCHORAGE, ALASKA 99508  
Ph: 907.729.3378



**ARCHITECT & LANDSCAPE**  
KPB ARCHITECTS  
500 L STREET, SUITE 400  
ANCHORAGE, ALASKA 99501  
Ph: 907.274.7443



**MEP ENGINEER**  
RSA ENGINEERING  
670 W FIREWEED LANE, SUITE 200  
ANCHORAGE, ALASKA 99503  
Ph: 907.276.0521





### GENERAL NOTES

- ALL CONSTRUCTION SHALL COMPLY WITH APPLICABLE CODES AS ADOPTED AND AMENDED BY CITY OF ANCHORAGE.
- THESE DRAWINGS ARE SUPPLIED TO THE CONTRACTOR AND OTHERS FOR THEIR USE FOR THIS SPECIFIC PROJECT. ALL COPIES OF THESE DRAWINGS SHALL REMAIN THE PROPERTY OF kpb architects. AND SHALL NOT BE REUSED OR REPRODUCED WITHOUT PERMISSION OF kpb architects.
- THE ORGANIZATION OF DOCUMENTS ARE NOT INTENDED TO CONTROL THE DIVISION OF WORK. DIVISION OF WORK SHALL BE THE SOLE RESPONSIBILITY OF THE CONTRACTOR.
- DIMENSIONS ARE TO FACE OF STUD, FACE OF MASONRY, FACE OF CONCRETE OR GRID LINE AT NEW CONSTRUCTION AND FACE OF EXISTING FINISH AT EXISTING CONSTRUCTION UNLESS OTHERWISE NOTED.
- CONTRACTOR SHALL VERIFY DIMENSIONS, REQUIRED CLEARANCES, AND POWER AND PLUMBING REQUIREMENTS FOR ALL OWNER AND NIC ITEMS. NOTIFY ARCHITECT OF ANY DISCREPANCIES PRIOR TO COMMENCEMENT OF WORK.
- EXISTING CONDITIONS SHOWN ARE BASED ON RECORD DRAWINGS AND / OR ORIGINAL CONSTRUCTION DRAWINGS. CONTRACTOR SHALL VERIFY EXISTING CONDITIONS AND DIMENSIONS PRIOR TO COMMENCEMENT OF WORK. NOTIFY ARCHITECT OF ANY DISCREPANCIES PRIOR TO COMMENCEMENT OF WORK.
- WHERE DIMENSIONS ARE NOT INDICATED, THE DRAWINGS ARE NOT INTENDED TO BE SCALED. NOTIFY ARCHITECT FOR ADDITIONAL INFORMATION FOR ANY DISCREPANCIES AND CLARIFICATIONS BEFORE COMMENCING WITH ANY RELATED WORK.

### DRAWING SYMBOLS

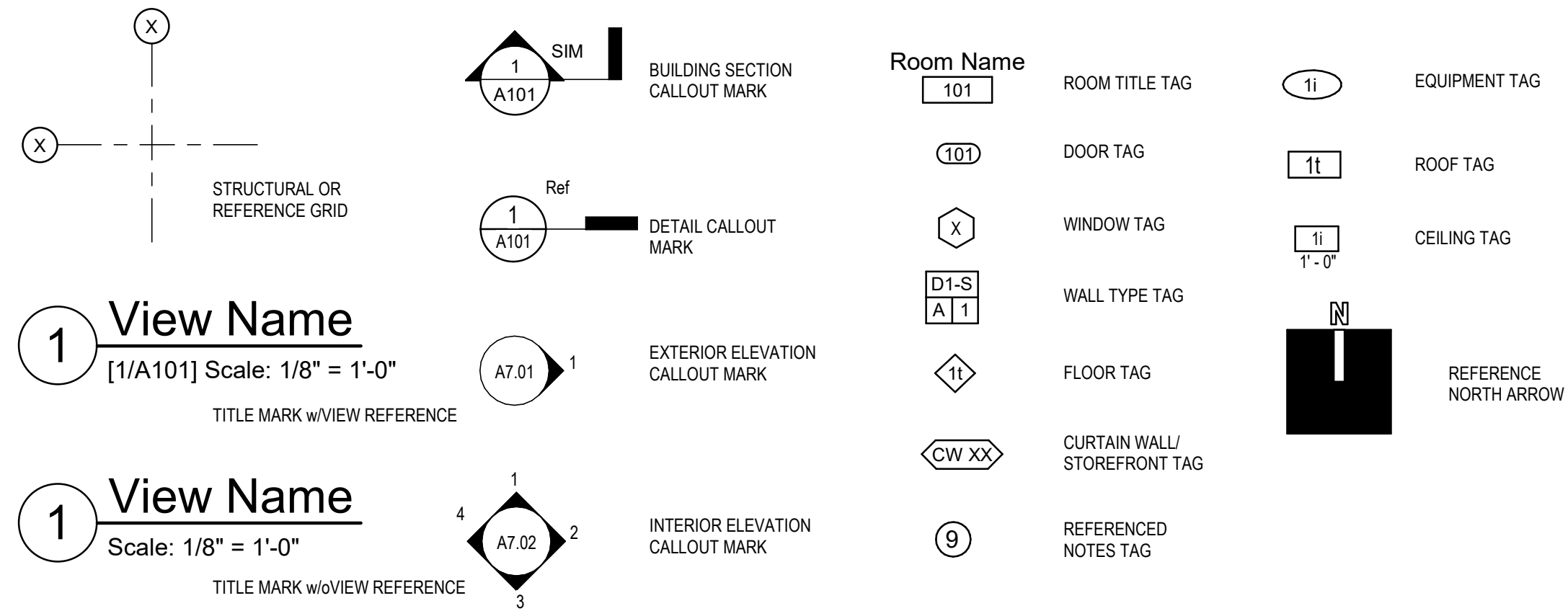

### POCHE LEGEND

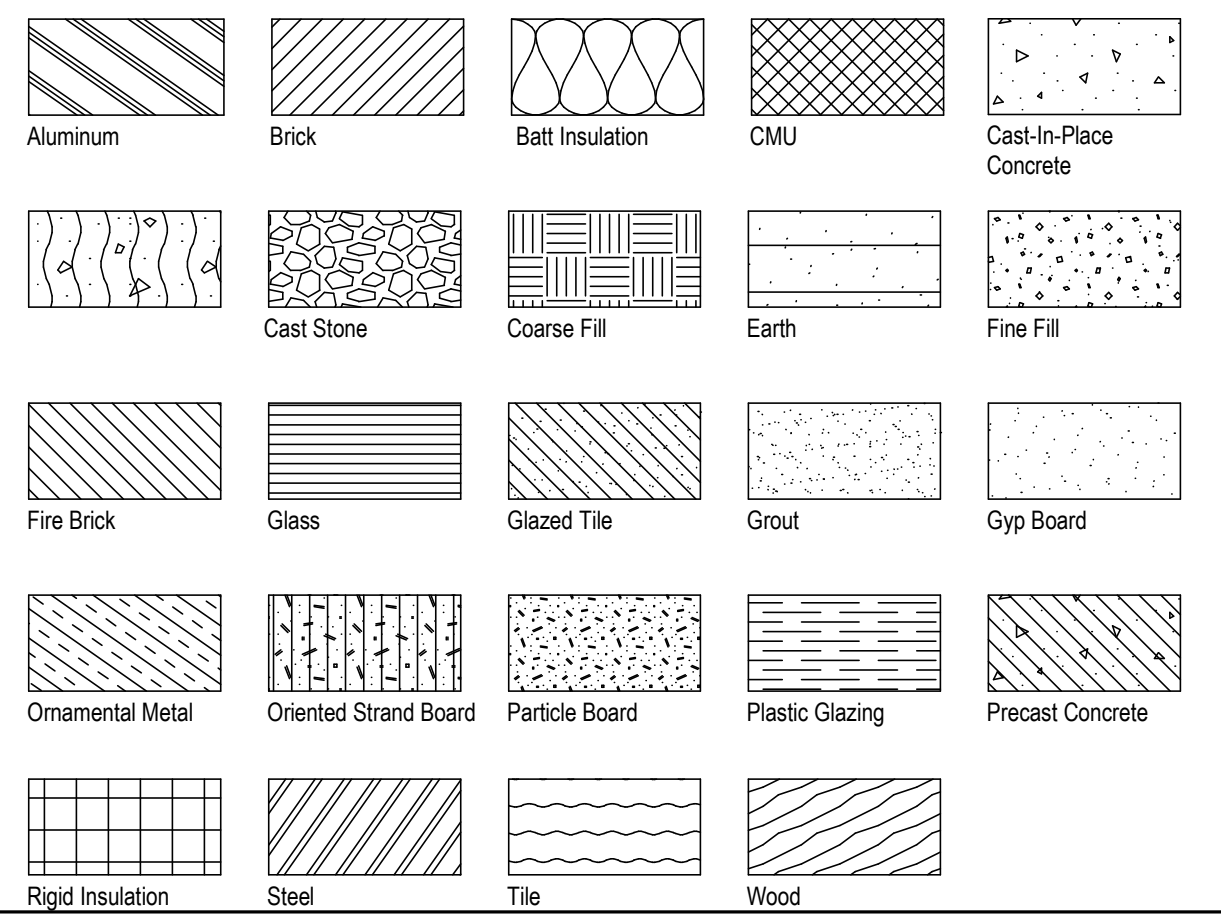

STAMP

KPB ARCHITECTS

500 L STREET, SUITE 400  
ANCHORAGE, AK 99501  
(907) 276-0221  
WWW.KPBARCHITECTS.COM  
AK CORPORATION # 34552 D  
AK CORPORATION # 34552 D

### GENERAL ABBREVIATIONS

AB	ANCHOR BOLT	DIM	DIMENSION	GWB	GYPSUM WALLBOARD	NO	NUMBER	SJ	SEISMIC JOINT
AC	ASPHALTIC CONCRETE	DN	DOWN	GYP	GYPSUM	NOM	NOMINAL	SLR	SEALER
ACM	ALUMINUM COMPOSITE PANEL	DR	DOOR			NR	NON-RATED	SNC	SANITARY NAPKIN CABINET
ACST	ACOUSTICAL	DS	DOWNSPOUT	HB	HOSE BIB	NTS	NOT TO SCALE	SND	SANITARY NAPKIN DISPENSER
ACT	ACOUSTICAL CEILING TILE	DWG	DRAWING	HC	HANDICAPPED	O/A	OUTSIDE AIR	SNR	SANITARY NAPKIN RECEPTACLE
ADDN	ADDITION / ADDITIONAL	DWR	DRAWER	HCWD	HOLLOW CORE WOOD	O/C	ON CENTER	SPEC	SPECIFICATION(S)
ADJ	ADJACENT / ADJUSTABLE			HDO	HIGH DENSITY OVERLAY	OD	OUTSIDE DIAMETER	SQ	SQUARE
AFF	ABOVE FINISHED FLOOR	E	EAST	HDWD	HARDWOOD	OFFC	OWNER FURNISHED-CONTRACTOR INSTALLED	SS	STAINLESS STEEL
AHU	AUTHORITY HAVING JURISDICTION	E/A	EXHAUST AIR	HDWR	HARDWARE	OFFO	OWNER FURNISHED-OWNER INSTALLED	SSM	SOLID SURFACE MATERIAL
AHU	AIR HANDLING UNIT	EA	EACH	HM	HOLLOW METAL	OFF	OFFICE	ST	STAIN
ALT	ALTERNATE	EHD	ELECTRIC HAND DRYER	HND	HAND	OFFO	OWNER FURNISHED-OWNER INSTALLED	STD	STANDARD
ALUM	ALUMINUM	EIFS	EXTERIOR INSULATION FINISH SYSTEM	HORIZ	HORIZONTAL	OPNG	OPENING	STF	STOREFRONT
ANOD	ANODIZED	EL	ELEVATION	HR	HOUR	OPP	OPPOSITE	STL	STEEL
AP	ACOUSTICAL PANEL	ELEC	ELECTRICAL	HT / H	HEIGHT	ORD	OVERFLOW ROOF DRAIN	STO	STORAGE
APPROX	APPROXIMATE(LY)	ELEV	ELEVATOR	HTG	HEATING	ORIG	ORIGINAL	STRUC	STRUCTURE / STRUCTURAL
ARCH	ARCHITECT / ARCHITECTURAL	ENCL	ENCLOSURE	HVAC	HEATING, VENTILATION AND AIR CONDITIONING	PBD	PARTICLE BOARD	SUBST	SUBSTRATE
		ENGR	ENGINEER			PL	PROPERTY LINE / PLATE	SUSP	SUSPEND(ED)
BBT	BIOBASED TILE	EPDM	ETHYLENE PROPYLENE DIENE MONOMER	IBC	INTERNATIONAL BUILDING CODE	PLM	PLASTIC LAMINATE	SV	SHEET VINYL
BD	BOARD	EQ	EQUAL	ID	INSIDE DIAMETER	PLAS	PLASTER	T	TREAD
BLDG	BUILDING	EQUIP	EQUIPMENT	IHM	INSULATED HOLLOW METAL	PLWD	PLYWOOD	T&G	TONGUE AND GROOVE
BLK	BLOCK	EW	EACH WAY	IMP	INSULATED METAL PANEL	PNL	PANEL	TB	TOWEL BAR
BLKG	BLOCKING	EXH	EXHAUST	IN	INCH	PR	PAIR	TB	THERMAL BREAK / TACK BOARD
BM	BEAM	EXP	EXPANSION / EXPANDED	INFO	INFORMATION	PRCST	PRECAST	TEL	TELEPHONE
BO	BOTTOM OF	EXP JT	EXPANSION JOINT	INSUL	INSULATION	PREFAB	PREFABRICATED	TEMP	TEMPERATURE
BOD	BOTTOM OF DECK	EXST	EXISTING	INT	INTERIOR	PREFIN	PREFINISHED	THK	THICKNESS
BOT	BOTTOM	EXT	EXTERIOR	INV	INVERT	PROJ	PROJECT	THOLD	THRESHOLD
BRG	BEARING	EXTR	EXTRUDED	JAN	JANITOR	PSF	POUNDS PER SQUARE FOOT	THRU	THROUGH
BSMT	BASEMENT			JST	JOIST	PT	POUNDS PER SQUARE INCH	TLT	TOILET
BTWN	BETWEEN	F	FAHRENHEIT	JT	JOINT	PTD	PAPER TOWEL DISPENSER	TO	TOP OF
BUR	BUILT-UP ROOF	FA	FIRE ALARM			PTDR	PAPER TOWEL DISPENSER AND RECEPTACLE	TOM	TOP OF MASONRY
		FAB	FABRICATE(D)	KD	KNOCKDOWN	PTN	PARTITION	TOW	TOP OF WALL
C	CELSIUS	FACP	FIRE ALARM CONTROL PANEL	KIT	KITCHEN	PTR	PAPER TOWEL RECEPTACLE	TPD	TOILET PAPER DISPENSER
CAB	CABINET	FD	FLOOR DRAIN	KO	KNOCKOUT	PVC	POLYVINYL CHLORIDE	TPTN	TOILET PARTITION
CB	CHALK BOARD	FDC	FIRE DEPARTMENT CONNECTION	KPL	KICK PLATE	QT	QUARRY TILE	TS	TUBE STEEL / TOILETRY SHELF
CBB	CEMENT BACKER BOARD	FDN	FOUNDATION	LAB	LABORATORY	R	RISER	TSTAT	THERMOSTAT
CCTV	CLOSED CIRCUIT TELEVISION	FE	FIRE EXTINGUISHER	LAM	LAMINATE	R/A	RETURN AIR	TYP	TYPICAL
CG	CORNER GUARD	FEC	FIRE EXTINGUISHER CABINET	LAV	LAVATORY	RAD	RADIUS	TZ	TERRAZZO
CHKRD	CHECKERED	FF	FACTORY FINISHED	LB	POUND	RB	RUBBER / RUBBER BASE	UG	UNDERGROUND
CJ	CONTROL JOINT	FG	FIBERGLASS	LBL	LABEL	RCP	REFLECTED CEILING PLAN	UH	UNIT HEATER
CL	CENTERLINE	FHC	FIRE HOSE CABINET	LDY	LAUNDRY	RD	ROOF DRAIN	UL	UNDERWRITER'S LABORATORY
CLG	CEILING	FHMS	FLAT HEAD MACINE SCREW	LDR	LAUNDRY	REF	REFERENCE	UNFIN	UNFINISHED
CLO	CLOSET	FHWS	FLAY HEAD WOOD SCREW	LIN	LINOLEUM	REINF	REINFORCE(D) (ING) (MENT)	UNON	UNLESS OTHERWISE NOTED
CLR	CLEAR	FIG	FIGURE	LIN	LINOLEUM	REQD	REQUIRED	UR	URINAL
CMP	CORRUGATED METAL PIPE	FIN	FINISH	LNB	LINEAL FOOT	RESIL	RESILIENT	VAC	VACUUM
CMU	CONCRETE MASONRY UNIT	FIN FLR	FINISH FLOOR	LNL	LINEAL	REV	REVISE / REVISION	VAR	VARIABLE
CO	CLEAN OUT	FIN GR	FINISH GRADE	LNR	LOCKER	RFG	RESILIENT FLOORING	VCT	VINYL COMPOSITION TILE
COL	COLUMN	FLG	FLASHING	LNR	LOCKER	RFS	ROOFING	VERT	VERTICAL
COMM	COMMUNICATION	FLR	FLOOR	LT	LIGHT	RHK	ROBE HOOK	VEST	VESTIBULE
CONC	CONCRETE	FLRG	FLOORING	LVR	LOUVER	RHMS	ROUND HEAD MACHINE SCREW	VR	VAPOR RETARDER
CONN	CONNECTION	FOC	FACE OF CONCRETE	MATL	MATERIAL	RHWS	ROUND HEAD WOOD SCREW	VTR	VENT THROUGH ROOF
CONST	CONSTRUCTION	FOF	FACE OF FINISH	MAX	MAXIMUM	RL	RAIN LEADER	W	WEST / WIDTH
CONT	CONTINUOUS	FOM	FACE OF MASONRY	MB	MACHINE BOLT	RM	ROOM	W/O	WITHOUT
CONTR	CONTRACT(OR)	FOS	FACE OF STUD	MDF	MEDIUM DENSITY FIBERBOARD	RND	ROUND	WB	WOOD BASE
CONV	CONVECTOR	FOW	FACE OF WALL	MDO	MEDIUM DENSITY OVERLAY	RO	ROUGH OPENING	WC	WATER CLOSET
COORD	COORDINATE	FPRF	FIRE PROOFING	MECH	MECHANICAL	RTR	RUBBER TREAD & RISER	WD	WOOD
COORD	COORDINATE	FR	FIRE RATING	MEP	MECHANICAL, ELECTRICAL AND PLUMBING	S	SOUTH	WDO	WINDOW
CORR	CORRIDOR	FRP	FIBERGLASS REINFORCED PANEL	MEZ	MEZZANINE	S/A	SUPPLY AIR	WF	WIDE FLANGE
CPT	CARPET	FRT	FIRE RETARDANT TREATED	MFG	MANUFACTURER(ED)	SB	SHOWER BENCH	WP	WATERPROOF(ING)
CSK	COUNTERSINK	FT	FOOT / FEET	MH	MANHOLE	SC	SOLID CORE	WR	WATER RESISTANT / WASTE RECEPTACLE
CSMT	CASEMENT	FTG	FOOTING	MHK	MOP HOOK	SCD	SEAT COVER DISPENSER	WSCOT	WAINSCOT
CT	CERAMIC TILE	FXTR	FIXTURE	MILWK	MILLWORK	SCHED	SCHEDULE	WT	WEIGHT
CTR	CENTER(ED)			MIN	MINIMUM	SCWD	SOLID CORE WOOD	WWF	WELDED WIRE FABRIC
CU	CUBIC			MIR	MIRROR	SD	STORM DRAIN / SOAP DISPENSER		
CUH	CABINET UNIT HEATER	GA	GAUGE	MISC	MISCELLANEOUS	SECT	SECTION		
CW	CURTAIN WALL	GALV	GALVANIZED	MLDG	MOULDING	SF	SQUARE FOOT / FEET		
		GB	GRAB BAR	MMB	MEMBRANE	SHT	SHEET		
D	DEPTH	GC	GENERAL CONTRACTOR	MO	MASONRY OPENING	SHTG	SHEATHING		
DBL	DOUBLE	GCMU	GLAZED CONCRETE MASONRY UNIT	MTD	MOUNTED	SHWR	SHOWER		
DCS	DIAPER CHANGING STATION	GEN	GENERAL	MTL	METAL	SIM	SIMILAR		
DEG	DEGREE	GL	GLASS	MTR BD	MORTAR BED				
DEMO	DEMOLITION	GLB	GLUE LAM BEAM						
DEPT	DEPARTMENT	GLU-LAM	GLUE LAMINATED	N	NORTH				
DET	DETAIL	GMGWB	GLASS MESH GYPSUM WALL BOARD	NA	NOT APPLICABLE				
DF	DRINKING FOUNTAIN	GOV	GOVERNMENT	NAT FIN	NATURAL FINISH				
DFC	DRINKING FOUNTAIN - COOLER	GR	GRADE	NFS	NON FROST SUSCEPTIBLE				
DIA	DIAMETER	GRTG	GRATING	NIC	NOT IN CONTRACT				
DIFF	DIFFUSER	GSP	GALVANIZED STEEL PIPE	NLB	NON LOAD BEARING				

### SHEET INDEX

GENERAL	G000	COVER SHEET
	G001	VICINITY MAP/GENERAL NOTES/SHEET INDEX
ARCHITECTURE	A001	GENERAL ARCHITECTURAL INFORMATION
	A004	OVERALL PCC FLOOR PLAN - LEVEL 1
ELECTRICAL	E001	ELECTRICAL LEGEND, GENERAL NOTES, AND DETAILS
	E002	ELECTRICAL SPECIFICATIONS
	E101	PCC I - FIRST FLOOR FIRE ALARM PLAN
	E102	PCC II - FIRST FLOOR - NIC
	E103	PCC III - FIRST FLOOR FIRE ALARM PLAN
	E104	PCC I - SECOND FLOOR FIRE ALARM PLAN
	E105	PCC II - SECOND FLOOR - NIC
	E106	PCC III - SECOND FLOOR FIRE ALARM PLAN
	E107	PCC III - THIRD FLOOR FIRE ALARM PLAN



VICINITY MAP



**RSIA Engineering, Inc.**  
MECHANICAL AND ELECTRICAL CONSULTING ENGINEERS  
1000 W. 11th Avenue, Anchorage, AK 99503 (907) 276-0221  
Corporate No.: ALEC0242

**SOUTHCENTRAL FOUNDATION  
PCC FIRE ALARM STROBE LIGHT  
UPGRADES  
BID DOCUMENTS**

4320 DIPLOMACY DRIVE ANCHORAGE, AK 99508

REVISION SCHEDULE	
#	DESCRIPTION

JOB NO.	20064.03
DATE	07.11.2023
DRAWN	KSA
REVIEWED	JS

SHEET NAME  
VICINITY MAP/GENERAL  
NOTES/SHEET INDEX

SHEET NO.  
**G001**

HALF-SCALE AT 11X17



**DRAWING SYMBOLS**

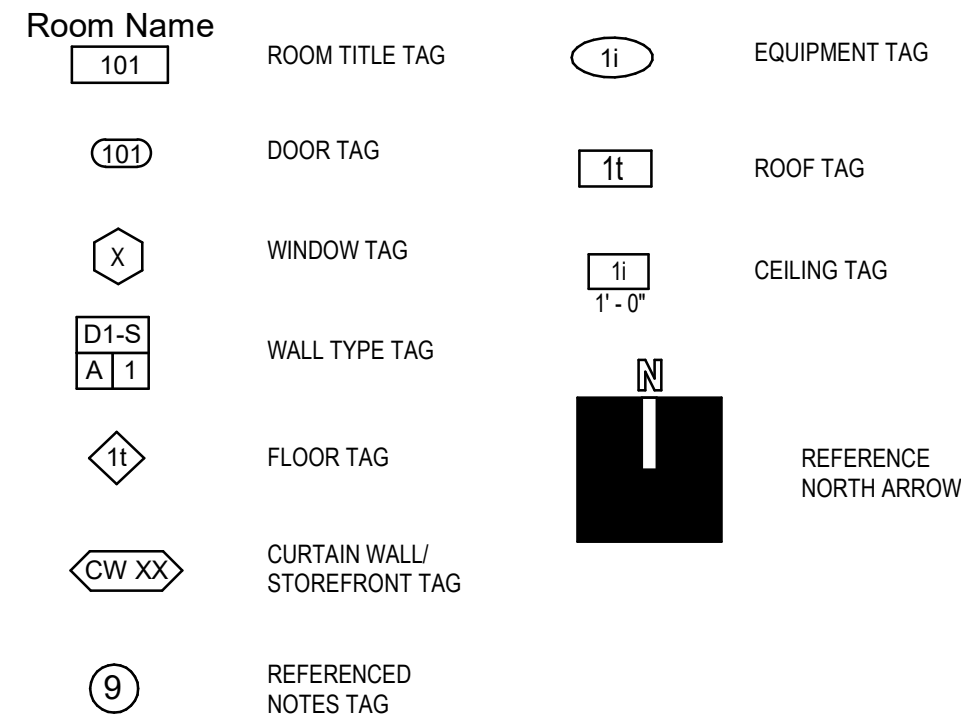
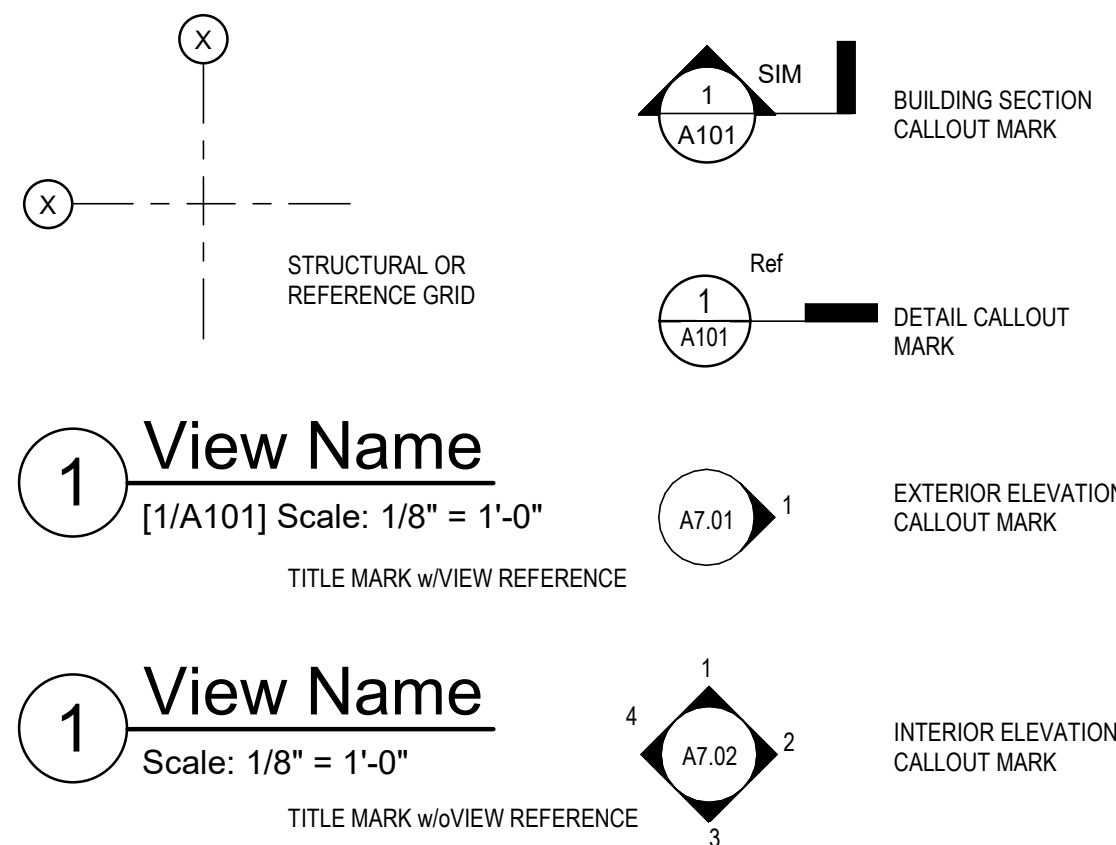

**POCHE LEGEND**

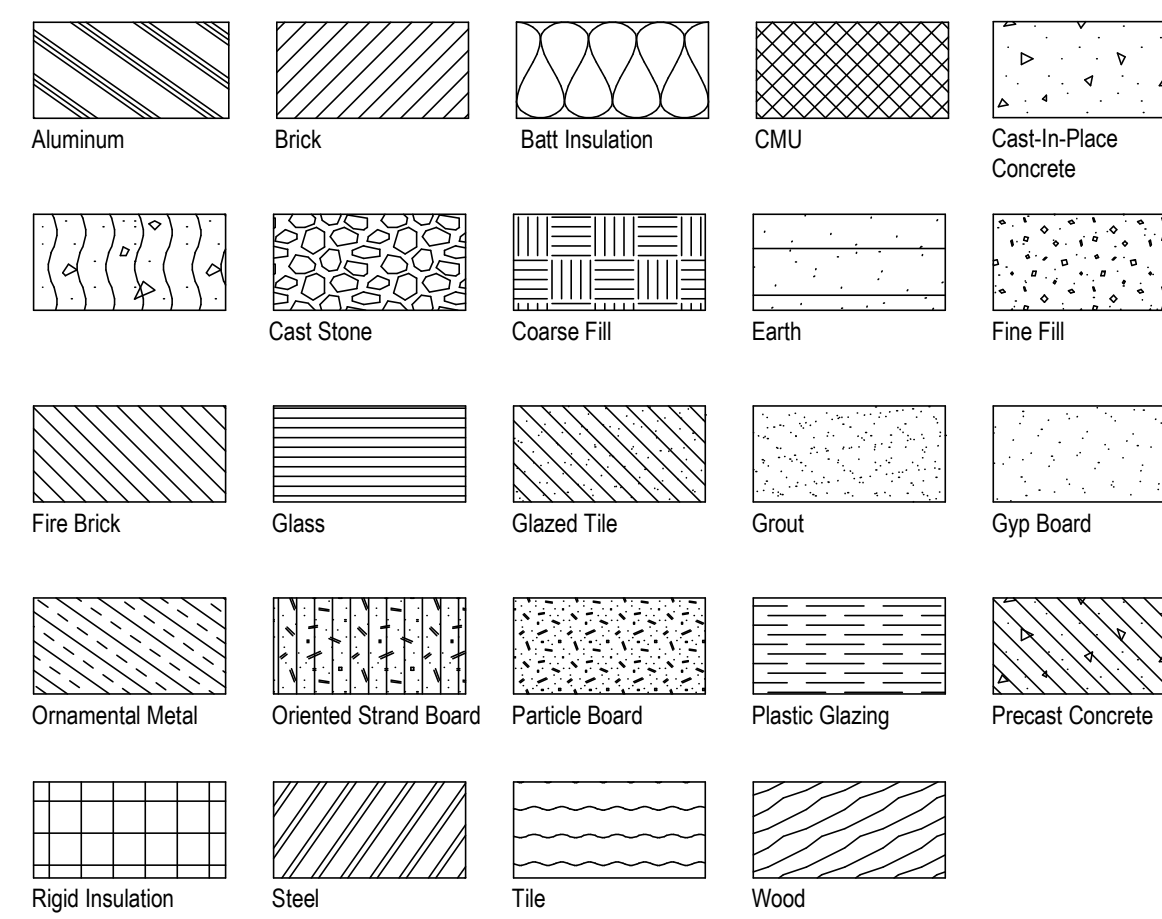

**GENERAL ARCHITECTURAL NOTES**

- DIMENSIONS ARE TO FACE OF STUD, FACE OF MASONRY, FACE OF CONCRETE OR GRID LINE AT NEW CONSTRUCTION AND FACE OF EXISTING FINISH AT EXISTING CONSTRUCTION UNLESS OTHERWISE NOTED.
- WHERE DIMENSIONS ARE NOT INDICATED, THE DRAWINGS ARE NOT INTENDED TO BE SCALED. NOTIFY ARCHITECT FOR ADDITIONAL INFORMATION FOR ANY DISCREPANCIES AND CLARIFICATIONS BEFORE COMMENCING WITH ANY RELATED WORK.

**GENERAL ABBREVIATIONS**

AB	ANCHOR BOLT	DIM	DIMENSION	GWB	GYPSUM WALLBOARD	NO	NUMBER	SJ	SEISMIC JOINT
AC	ASPHALTIC CONCRETE	DN	DOWN	GYP	GYPSUM	NOM	NOMINAL	SLR	SEALER
ACM	ALUMINUM COMPOSITE PANEL	DR	DOOR	HC	HOSE BIB	NR	NON-RATED	SNL	SANITARY NAPKIN CABINET
ACST	ACOUSTICAL	DS	DOWNSPOUT	HB	HANDICAPPED	NTS	NOT TO SCALE	SND	SANITARY NAPKIN DISPENSER
ACT	ACOUSTICAL CEILING TILE	DWG	DRAWING	HCWD	HOLLOW CORE WOOD	O/A	OUTSIDE AIR	SNR	SANITARY NAPKIN RECEPTACLE
ADDN	ADDITION / ADDITIONAL	DWR	DRAWER	HDO	HIGH DENSITY OVERLAY	OC	ON CENTER	SPEC	SPECIFICATION(S)
ADJ	ADJACENT / ADJUSTABLE	E	EAST	HDWD	HARDWOOD	OD	OUTSIDE DIAMETER	SQ	SQUARE
AFF	ABOVE FINISHED FLOOR	E/A	EXHAUST AIR	HDWR	HARDWARE	OCF	OWNER FURNISHED-CONTRACTOR INSTALLED	SS	STAINLESS STEEL
AHJ	AUTHORITY HAVING JURISDICTION	EA	EACH	HND	HAND	OFF	OFFICE	SSM	SOLID SURFACE MATERIAL
AHU	AIR HANDLING UNIT	EHD	ELECTRIC HAND DRYER	HM	HOLLOW METAL	OFI	OWNER FURNISHED-OWNER INSTALLED	ST	STAIN
ALT	ALTERNATE	EIFS	EXTERIOR INSULATION FINISH SYSTEM	HND	HAND	OH	OVERHEAD	STD	STANDARD
ALUM	ALUMINUM	EL	ELEVATION	HORIZ	HORIZONTAL	OPNG	OPENING	STF	STOREFRONT
ANOD	ANODIZED	ELEC	ELECTRICAL	HR	HOUR	OPP	OPPOSITE	STL	STEEL
AP	ACOUSTICAL PANEL	ELEV	ELEVATOR	HT / H	HEIGHT	ORD	OVERFLOW ROOF DRAIN	STO	STORAGE
APPROX	APPROXIMATE(LY)	ENCL	ENCLOSURE	HTG	HEATING	ORD	OVERFLOW ROOF DRAIN	STRUC	STRUCTURE / STRUCTURAL
ARCH	ARCHITECT / ARCHITECTURAL	ENGR	ENGINEER	HVAC	HEATING, VENTILATION AND AIR CONDITIONING	ORIG	ORIGINAL	SUBST	SUBSTRATE
BBT	BIOBASED TILE	EPDM	ETHYLENE PROPYLENE DIENE MONOMER	IBC	INTERNATIONAL BUILDING CODE	PBD	PARTICLE BOARD	SUSP	SUSPENDED
BD	BOARD	EQ	EQUAL	ID	INSIDE DIAMETER	PL	PROPERTY LINE / PLATE	SV	SHEET VINYL
BLDG	BUILDING	EQUIP	EQUIPMENT	IHM	INSULATED HOLLOW METAL	PLAM	PLASTIC LAMINATE	T	TREAD
BLK	BLOCK	EW	EACH WAY	IMP	INSULATED METAL PANEL	PLAS	PLASTER	T&G	TONGUE AND GROOVE
BLKG	BLOCKING	EXH	EXHAUST	IN	INCH	PLWD	PLYWOOD	TB	TOWEL BAR
BM	BEAM	EXP	EXPANSION / EXPANDED	INFO	INFORMATION	PNL	PANEL	TB	THERMAL BREAK / TACK BOARD
BO	BOTTOM OF	EXP JT	EXPANSION JOINT	INSUL	INSULATION	PR	PAIR	TEL	TELEPHONE
BOD	BOTTOM OF DECK	EXST	EXISTING	INT	INTERIOR	PRCST	PRECAST	TEMP	TEMPERATURE
BOT	BOTTOM	EXT	EXTERIOR	INV	INVERT	PREFAB	PREFABRICATED	THK	THICK(NESS)
BRG	BEARING	EXTR	EXTRUDED	JAN	JANITOR	PREFIN	PREFINISHED	THOLD	THRESHOLD
BSMT	BASEMENT	F	FAHRENHEIT	JST	JOIST	PROJ	PROJECT	THRU	THROUGH
BTWN	BETWEEN	FA	FIRE ALARM	JT	JOINT	PSF	POUNDS PER SQUARE FOOT	TLT	TOILET
BUR	BUILT-UP ROOF	FAB	FABRICATE(D)	KD	KNOCKDOWN	PSI	POUNDS PER SQUARE INCH	TO	TOP OF
C	CELSIUS	FACP	FIRE ALARM CONTROL PANEL	KIT	KITCHEN	PT	PAINT / POST TENSION	TOM	TOP OF MASONRY
CAB	CABINET	FD	FLOOR DRAIN	KO	KNOCKOUT	PTD	PAPER TOWEL DISPENSER	TOW	TOP OF WALL
CB	CHALK BOARD	FDC	FIRE DEPARTMENT CONNECTION	KIP	KICKOUT	PTDR	PAPER TOWEL DISPENSER AND RECEPTACLE	TPD	TOILET PAPER DISPENSER
CBB	CEMENT BACKER BOARD	FDN	FOUNDATION	KPL	KICK PLATE	PTN	PARTITION	TPTN	TOILET PARTITION
CCTV	CLOSED CIRCUIT TELEVISION	FE	FIRE EXTINGUISHER	LAB	LABORATORY	PTR	PAPER TOWEL RECEPTACLE	TS	TUBE STEEL / TOILETRY SHELF
CG	CORNER GUARD	FEC	FIRE EXTINGUISHER CABINET	LAM	LAMINATE	PVC	POLYVINYL CHLORIDE	TS/STAT	THERMOSTAT
CHKRD	CHECKERED	FF	FACTORY FINISHED	LAV	LAVATORY	QT	QUARRY TILE	TV	TELEVISION
CJ	CONTROL JOINT	FG	FIBERGLASS	LB	POUND	R	RISER	TYP	TYPICAL
CL	CENTERLINE	FHC	FIRE HOSE CABINET	LBL	LABEL	R/A	RETURN AIR	TZ	TERRAZZO
CLG	CEILING	FHMS	FLAT HEAD MACHINE SCREW	LDRY	LAUNDRY	RAD	RADIUS	UG	UNDERGROUND
CLO	CLOSET	FHWS	FLAY HEAD WOOD SCREW	LF	LINEAR FOOT	RB	RUBBER / RUBBER BASE	UH	UNIT HEATER
CLR	CLEAR	FIG	FIGURE	LIN	LINOLEUM	RCP	REFLECTED CEILING PLAN	UL	UNDERWRITER'S LABORATORY
CMP	CORRUGATED METAL PIPE	FIN	FINISH	LKR	LOCKER	RD	ROOF DRAIN	UNFIN	UNFINISHED
CMU	CONCRETE MASONRY UNIT	FIN FLR	FINISH FLOOR	LT	LIGHT	REF	REFERENCE	UON	UNLESS OTHERWISE NOTED
CO	CLEAN OUT	FIN GR	FINISH GRADE	LVR	LOUVER	REIN	REINFORCE(D) (ING) (MENT)	UR	URINAL
COL	COLUMN	FLR	FLOOR	MATL	MATERIAL	REQD	REQUIRED	VAC	VACUUM
COMM	COMMUNICATION	FLRG	FLOORING	MAX	MAXIMUM	RESIL	RESILIENT	VAR	VARIABLE
CONC	CONCRETE	FOC	FACE OF CONCRETE	MB	MACHINE BOLT	REV	REVISE / REVISION	VCT	VINYL COMPOSITION TILE
CONN	CONNECTION	FOF	FACE OF FINISH	MDF	MEDIUM DENSITY FIBERBOARD	RF	RESILIENT FLOORING	VERT	VERTICAL
CONST	CONSTRUCTION	FOM	FACE OF MASONRY	MDO	MEDIUM DENSITY OVERLAY	RFG	ROOFING	VEST	VESTIBULE
CONT	CONTINUOUS	FOS	FACE OF STUD	MECH	MECHANICAL	RFS	RAISED FLOOR SYSTEM	VR	VAPOR RETARDER
CONTR	CONTRACT(OR)	FOW	FACE OF WALL	MEP	MECHANICAL, ELECTRICAL AND PLUMBING	RHK	ROBE HOOK	VTR	VENT THROUGH ROOF
CONV	CONVECTOR	FPRF	FIRE PROOFING	MEZZ	MEZZANINE	RHMS	ROUND HEAD MACHINE SCREW	W	WEST / WIDTH
COORD	COORDINATE	FR	FIRE RATING	MFG	MANUFACTURER(ED)	RHWS	ROUND HEAD WOOD SCREW	W	WITH
CORR	CORRIDOR	FRP	FIBERGLASS REINFORCED PANEL	MH	MANHOLE	RL	RAIN LEADER	W/O	WITHOUT
CPT	CARPET	FRT	FIRE RETARDANT TREATED	MHK	MOP HOOK	RM	ROOM	WB	WOOD BASE
CSK	COUNTERSINK	FT	FOOT / FEET	MILLWK	MILLWORK	RND	ROUND	WC	WATER CLOSET
CSMT	CASEMENT	FTG	FOOTING	MIN	MINIMUM	RO	ROUGH OPENING	WD	WOOD
CT	CERAMIC TILE	FXTR	FIXTURE	MIR	MIRROR	RTR	RUBBER TREAD & RISER	WDO	WINDOW
CTR	CENTER(ED)	GA	GAUGE	MISC	MISCELLANEOUS	S	SOUTH	WF	WIDE FLANGE
CJ	CUBIC	GALV	GALVANIZED	MLDG	MOULDING	S/A	SUPPLY AIR	WP	WATERPROOF(ING)
CUH	CABINET UNIT HEATER	GB	GRAB BAR	MMB	MEMBRANE	SB	SHOWER BENCH	WR	WATER RESISTANT / WASTE RECEPTACLE
CW	CURTAIN WALL	GC	GENERAL CONTRACTOR	MO	MASONRY OPENING	SC	SOLID CORE	WSC	WAINSCOT
D	DEPTH	GCMU	GLAZED CONCRETE MASONRY UNIT	MTD	MOUNTED	SCD	SEAT COVER DISPENSER	WT	WEIGHT
DBL	DOUBLE	GEN	GENERAL	MTL	METAL	SCHED	SCHEDULE	WWF	WELDED WIRE FABRIC
DCS	DIAPER CHANGING STATION	GL	GLASS	MTR BD	MORTAR BED	SCWD	SOLID CORE WOOD		
DEG	DEGREE	GLB	GLUE LAM BEAM	N	NORTH	SD	STORM DRAIN / SOAP DISPENSER		
DEMO	DEMOLITION	GLU-LAM	GLUE LAMINATED	NA	NOT APPLICABLE	SECT	SECTION		
DEPT	DEPARTMENT	GMGWB	GLASS MESH GYPSUM WALL BOARD	NAT FIN	NATURAL FINISH	SF	SQUARE FOOT / FEET		
DET	DETAIL	GOV	GOVERNMENT	NFS	NON FROST SUSCEPTIBLE	SHT	SHEET		
DF	DRINKING FOUNTAIN	GR	GRADE	NIC	NOT IN CONTRACT	SHTG	SHEATHING		
DFC	DRINKING FOUNTAIN - COOLER	GRG	GRATING	NLB	NON LOAD BEARING	SHWR	SHOWER		
DIA	DIAMETER	GSP	GALVANIZED STEEL PIPE			SIM	SIMILAR		
DIFF	DIFFUSER								

STAMP

KPB ARCHITECTS

500 L STREET, SUITE 400  
ANCHORAGE, AK 99501  
(907) 274-7448 (P) (907) 274-7407  
WWW.KPBARCHITECTS.COM  
AK CORPORATION # 34552 D

RISA Engineering, Inc.  
MECHANICAL AND ELECTRICAL CONSULTING ENGINEERS  
10000 S. WILLOW BLVD., SUITE 200 - ANCHORAGE, AK 99503 (907) 274-0221  
Corporate No.: REC0242

SOUTHCENTRAL FOUNDATION  
PCC FIRE ALARM STROBE LIGHT  
UPGRADES  
BID DOCUMENTS  
4320 DIPLOMACY DRIVE ANCHORAGE, AK 99508

REVISION SCHEDULE

#	DESCRIPTION	DATE

JOB NO.	20064.03
DATE	07.11.2023
DRAWN	KSA
REVIEWED	JS

SHEET NAME  
GENERAL ARCHITECTURAL  
INFORMATION

SHEET NO.  
**A001**

HALF-SCALE AT 11X17

C:\Users\kapplegate\Documents\01\_REVIT\_Locals\20064.03\_SCF\_PCC\_FIRE\_ALARM\_UPGRADES\_R23\_kapplegate\JMCS.rvt

# 1 OVERALL PCC FLOOR PLAN - LEVEL 1

Scale: 3/64" = 1'-0"

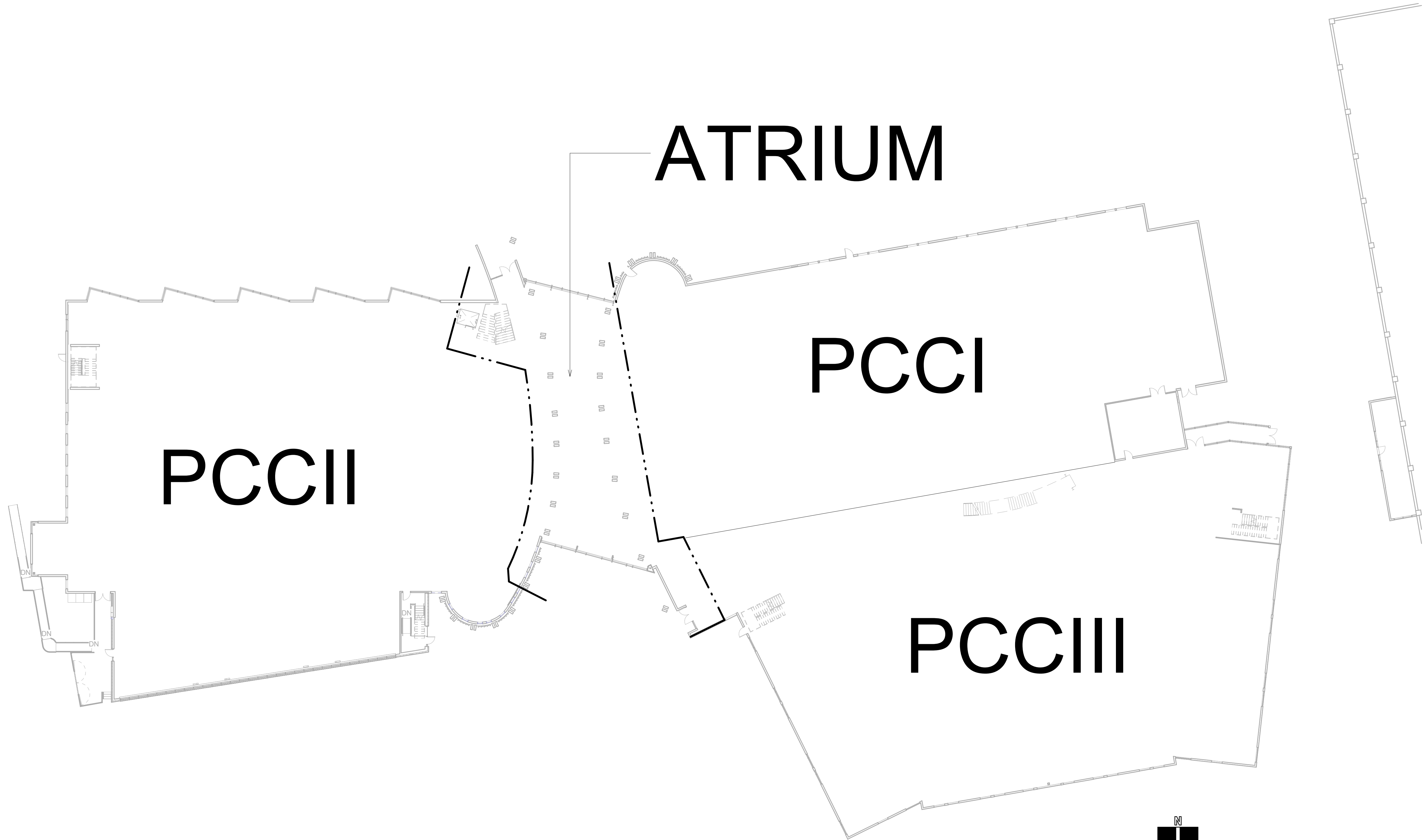

REVISION SCHEDULE	
#	DESCRIPTION

JOB NO.	20064.03
DATE	07.11.2023
DRAWN	KSA
REVIEWED	JS

SHEET NAME  
OVERALL PCC FLOOR  
PLAN - LEVEL 1

SHEET NO.  
**A004**

HALF-SCALE AT 11X17

**SOUTHCENTRAL FOUNDATION**  
**PCC FIRE ALARM STROBE LIGHT**  
**UPGRADES**  
**BID DOCUMENTS**  
4320 DIPLOMACY DRIVE ANCHORAGE, AK 99508

**RISA Engineering, Inc.**  
MECHANICAL AND ELECTRICAL CONSULTING ENGINEERS  
1000 North 20th Avenue, Suite 207, Anchorage, AK 99503 (907) 276-0221  
Corporate No.: RECCH24

**KPB ARCHITECTS**  
500 L STREET, SUITE 400  
ANCHORAGE, AK 99501  
(907) 274-7442 (907) 274-7407  
WWW.KPBARCHITECTS.COM  
AK CORPORATION # 3452 D





LEGEND	
	FIRE ALARM CONTROL PANEL - EXISTING
	NOTIFICATION APPLIANCE CIRCUIT BOOSTER POWER SUPPLY
	FIRE ALARM HORN/STROBE LIGHT (WALL, CLG MOUNTED)
	FIRE ALARM STROBE LIGHT (WALL, CLG MOUNTED)
	COPIER
	REFRIGERATOR
	NOTE TAG (No. INDICATES NOTE)
AFF	ABOVE FINISHED FLOOR
C	CONDUIT
E	DENOTES EXISTING ITEM
NEC	NATIONAL ELECTRICAL CODE

**GENERAL NOTES**

- A. EXISTING FIRE ALARM CONTROL PANEL IS EDWARDS EST-4. SEE E103.
- B. THIS PROJECT WILL UPGRADE NOTIFICATION THROUGHOUT THE BUILDING TO MEET MOA REQUIREMENTS DUE TO THE PANEL UPGRADE DURING A RENOVATION. NOTE THAT WORK WILL MOST LIKELY OCCUR CONCURRENTLY WITH THE RENOVATION PROJECT AND WILL REQUIRE COORDINATION WITH THAT PROJECT AND THE OWNER TO MINIMIZE DISRUPTION AND DOWNTIME.
- C. THERE IS NOT A COMPLETE SET OF SYSTEM AS-BUILTS. PROVIDE TIME AND DEVELOPMENT OF AS-BUILTS OF THE NOTIFICATION SYSTEM AS REQUIRED FOR MOA PLAN REVIEW.
- D. DEVICES MAY BE WALL OR CEILING MOUNTED AT CONTRACTOR'S OPTION. FINAL DETERMINATION SHALL BE PER NICET DESIGNER AND SHOWN ON SHOP DRAWINGS.
- E. VISUAL DEVICES SHALL BE SYNCHRONIZED WHERE REQUIRED. ADD DEVICES TO APPLICABLE NAC AFTER PERFORMING AS-BUILT EFFORTS.

**SHEET NOTES**

- 1. PROVIDE PROGRAMING AND TESTING AS REQUIRED FOR ALL NEW WORK.
- 2. CONNECT NEW DEVICES TO NEW OR EXISTING NAC BOOSTERS AS NEEDED.
- 3. SEE FLOOR PLANS FOR DEVICE QUANTITY AND LOCATION.

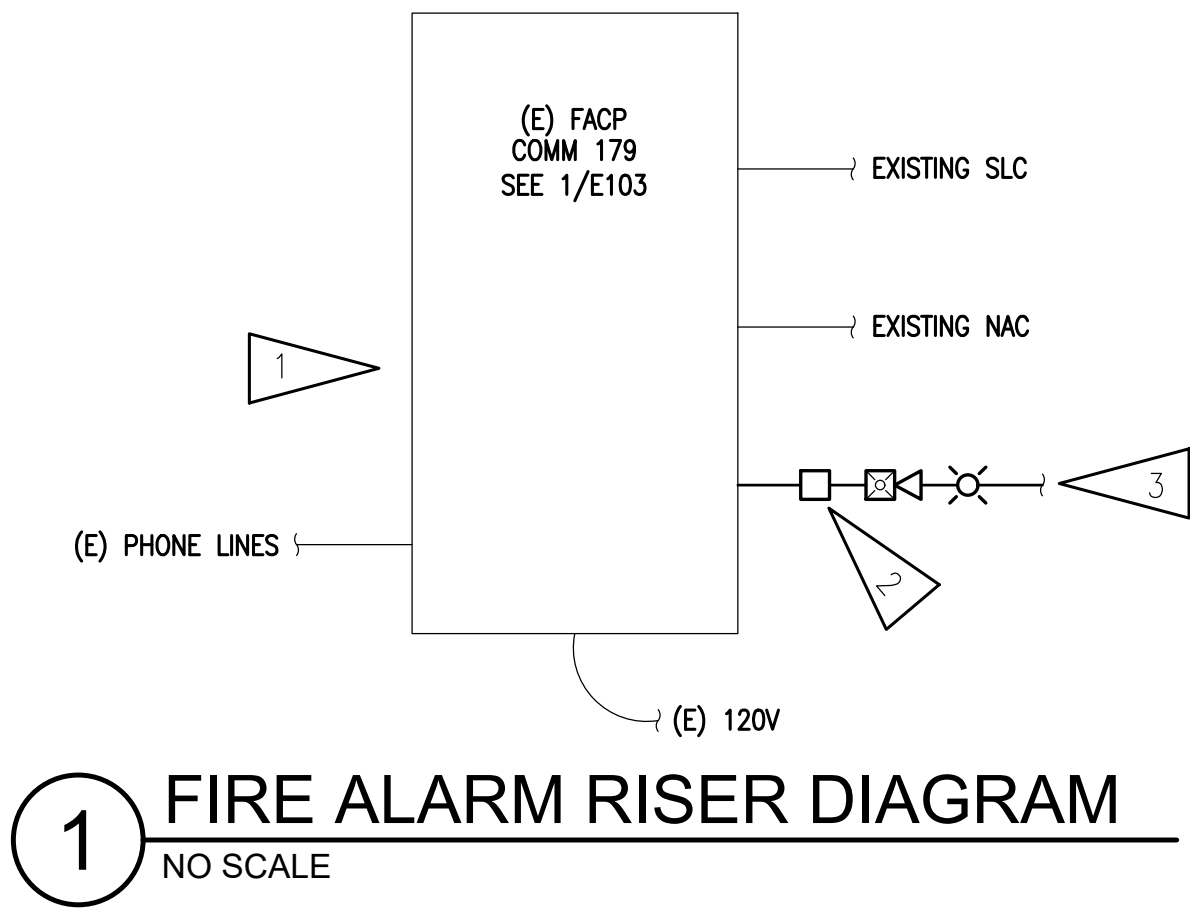

**KPB ARCHITECTS**  
 500 L STREET, SUITE 400  
 ANCHORAGE, AK 99501  
 (907) 274-7448 (907) 274-7407  
 WWW.KPBARCHITECTS.COM  
 AN CORPORATION # 84782 D

**RISA Engineering, Inc.**  
 MECHANICAL AND ELECTRICAL CONSULTING ENGINEERS  
 2000 W. 20th Ave., Anchorage, AK 99503 • (907) 276-0271  
 Corporate No.: ALEC0242

**SOUTHCENTRAL FOUNDATION  
 PCC FIRE ALARM STROBE LIGHT  
 UPGRADES  
 BID DOCUMENTS**  
 4320 DIPLOMACY DRIVE ANCHORAGE, AK 99508

REVISION SCHEDULE		
#	DESCRIPTION	DATE

JOB NO.	M0256
DATE	07.11.2023
DRAWN	CSZ
REVIEWED	JAM, XPT

SHEET NAME  
 ELECTRICAL LEGEND,  
 GENERAL NOTES, AND  
 DETAILS

SHEET NO.  
**E001**



# ELECTRICAL SPECIFICATIONS

## 26.05.00 - COMMON WORK RESULTS FOR ELECTRICAL

- A. SCOPE OF WORK: FURNISH AND INSTALL ALL MATERIAL AND EQUIPMENT FOR AN EXTENSION TO THE EXISTING ELECTRICAL SYSTEM AS INDICATED ON THE DRAWINGS AND IN THESE SPECIFICATIONS.
- B. STANDARDS, CODES AND REGULATIONS: COMPLY WITH THE LATEST ADOPTED EDITION OF THE NATIONAL ELECTRICAL CODE, INTERNATIONAL BUILDING CODE, AND INTERNATIONAL FIRE INCLUDING ALL STATE AND LOCAL AMENDMENTS TO THESE CODES. COMPLY WITH THE LATEST PUBLISHED VERSION OF THE NECA STANDARD OF INSTALLATION.
- C. DRAWINGS: THE DRAWINGS ARE DIAGRAMMATIC, NOT NECESSARILY SHOWING ALL OFFSETS OR EXACT LOCATIONS OF FIXTURES, EQUIPMENT, ETC. UNLESS SPECIFICALLY DIMENSIONED. REVIEW THE DRAWINGS AND SPECIFICATIONS FOR EQUIPMENT FURNISHED BY OTHER CRAFTS BUT INSTALLED IN ACCORDANCE WITH THIS SECTION. BRING QUESTIONABLE OR OBSCURE ITEMS, APPARENT CONFLICTS BETWEEN PLANS AND SPECIFICATIONS, GOVERNING CODES OR UTILITIES REGULATIONS TO THE ATTENTION OF THE ENGINEER. CODES, ORDINANCES, REGULATIONS, MANUFACTURER'S INSTRUCTIONS OR STANDARDS TAKE PRECEDENCE WHEN THEY ARE MORE STRINGENT OR CONFLICT WITH THE DRAWINGS AND SPECIFICATIONS.
- D. RECORD DRAWINGS: MARK UP A CLEAN SET OF DRAWINGS AS THE WORK PROGRESSES TO SHOW THE DIMENSIONED LOCATION AND ROUTING OF ALL ELECTRICAL WORK WHICH WILL BECOME PERMANENTLY CONCEALED. SHOW ROUTING OF WORK IN PERMANENTLY CONCEALED BLIND SPACES WITHIN THE BUILDING. SHOW COMPLETE ROUTING AND SIZING OF ANY SIGNIFICANT REVISIONS TO THE SYSTEMS SHOWN.
- E. WORKMANSHIP: INSTALLATION OF ALL WORK SHALL BE MADE SO THAT ITS SEVERAL COMPONENT PARTS SHALL FUNCTION AS A WORKABLE SYSTEM COMPLETE WITH ALL ACCESSORIES NECESSARY FOR ITS OPERATION. ALL MATERIAL AND EQUIPMENT SHALL BE INSTALLED IN ACCORDANCE WITH THE MANUFACTURER'S RECOMMENDATIONS, INSTRUCTIONS AND/OR INSTALLATION DRAWINGS AND IN ACCORDANCE WITH NECA STANDARDS. MATERIALS AND EQUIPMENT SHALL BE NEW AND SHALL CONFORM WITH APPLICABLE INDUSTRY STANDARDS, NEMA STANDARDS AND UNDERWRITERS LABORATORIES STANDARDS WHERE APPLICABLE.
- F. SUBMITTALS: PROVIDE MATERIAL AND EQUIPMENT SUBMITTALS CONTAINING A COMPLETE LISTING OF MATERIAL AND EQUIPMENT SHOWN ON THE DRAWINGS. INCLUDE CATALOG NUMBERS, WIRING DIAGRAMS, ROUGH-IN DIMENSIONS AND PERFORMANCE DATA FOR ALL MATERIAL AND EQUIPMENT. SUBMITTALS SHALL BE IN ELECTRONIC .PDF FORMAT, SEPARATE FROM WORK FURNISHED UNDER OTHER DIVISIONS. INDEX AND CLEARLY IDENTIFY ALL MATERIAL AND EQUIPMENT BY ITEM, NAME OR DESIGNATION USED ON THE DRAWINGS. SUBMITTAL REVIEW IS FOR GENERAL DESIGN AND ARRANGEMENT ONLY AND DOES NOT RELIEVE THE CONTRACTOR FROM ANY REQUIREMENTS OF THE CONTRACT DOCUMENTS. THE SUBMITTALS ARE NOT CHECKED FOR QUANTITY, DIMENSION, OR FOR PROPER OPERATION. WHERE DEVIATIONS OF A SUBSTITUTE PRODUCT OR SYSTEM PERFORMANCE HAVE NOT BEEN SPECIFICALLY NOTED IN THE SUBMITTAL BY THE CONTRACTOR, PROVISIONS OF A COMPLETE AND SATISFACTORY WORKING INSTALLATION IS THE SOLE RESPONSIBILITY OF THE CONTRACTOR.
- G. OPERATION AND MAINTENANCE MANUALS: PROVIDE OPERATION AND MAINTENANCE MANUALS FOR TRAINING OF THE OWNER'S PERSONNEL. DESCRIBE THE PROCEDURES NECESSARY TO OPERATE THE SYSTEM INCLUDING START-UP, OPERATION, EMERGENCY OPERATION AND SHUTDOWN. PROVIDE INSTRUCTIONS AND A SCHEDULE OF PREVENTIVE MAINTENANCE IN TABULAR FORM FOR ALL ROUTINE CLEANING, INSPECTION AND LUBRICATION WITH RECOMMENDED LUBRICANTS. PROVIDE INSTRUCTIONS FOR MINOR REPAIR OR ADJUSTMENTS REQUIRED FOR PREVENTIVE MAINTENANCE ROUTINES. PROVIDE MANUFACTURER'S DESCRIPTIVE LITERATURE INCLUDING APPROVED SHOP DRAWINGS COVERING DEVICES USED IN ANY CONTRACTOR-PROVIDED EQUIPMENT OR SYSTEMS WITH ILLUSTRATION, EXPLODED VIEWS, ETC.
- H. WARRANTY: THE CONTRACTOR SHALL GUARANTEE ALL WORK EXECUTED UNDER THIS CONTRACT TO BE FREE FROM DEFECTS IN MATERIALS AND WORKMANSHIP FOR A PERIOD OF ONE YEAR FROM BENEFICIAL OCCUPANCY. ANY FAULTY MATERIALS OR WORKMANSHIP SHALL BE REPAIRED OR REPLACED TO THE SATISFACTION OF THE OWNER DURING THE GUARANTEE PERIOD.
- I. PERMITS: SECURE AND PAY FOR ALL FEES, PERMITS, ETC. REQUIRED BY LOCAL AND STATE.
- J. REFERENCE SYMBOLS: THE ELECTRICAL "LEGEND" ON THE DRAWINGS IS A STANDARDIZED VERSION, AND ALL SYMBOLS SHOWN MAY NOT BE USED. USE THE "LEGEND" AS A REFERENCE FOR THE SYMBOLS USED ON THE DRAWINGS.
- K. PENETRATION OF FIRE BARRIERS: ALL ELECTRICAL PENETRATIONS THROUGH FIRE RATED BARRIERS SHALL BE SEALED IN ACCORDANCE WITH NEC ARTICLE 300.21 AND THE FOLLOWING:
- ALL HOLES OR VOIDS CREATED TO EXTEND ELECTRICAL SYSTEMS THROUGH FIRE RATED FLOORS, WALLS OR CEILING SHALL BE SEALED WITH AN ASBESTOS-FREE INTUMESCENT FIRE STOPPING MATERIAL CAPABLE OF EXPANDING 8 TO 10 TIMES WHEN EXPOSED TO TEMPERATURES 250 DEGREES F OR HIGHER.
  - MATERIALS SHALL BE SUITABLE FOR THE FIRE STOPPING OF PENETRATIONS MADE BY STEEL, GLASS, PLASTIC AND SHALL BE CAPABLE OF MAINTAINING AN EFFECTIVE BARRIER AGAINST FLAME, SMOKE AND GASES IN COMPLIANCE WITH THE REQUIREMENTS OF ASTM E814, UL 1479 AND THE UL FIRE RESISTANCE DIRECTORY REQUIREMENTS FOR THROUGH-PENETRATION FIRESTOP DEVICES (XHCR).

- THE RATING OF THE FIRE STOPS SHALL BE THE SAME AS THE TIME-RATED FLOOR, WALL OR CEILING ASSEMBLY.
- INSTALL FIRE STOPPING MATERIALS IN ACCORDANCE WITH THE MANUFACTURER'S INSTRUCTIONS.

## 26.05.19 - WIRE AND CABLE

- A. SUBMITTALS: NONE REQUIRED FOR THIS SECTION.
- B. MATERIALS:
- ALL CONDUCTORS SHALL BE COPPER WITH TYPE XHHW, THWN, THW OR THHN INSULATION. MINIMUM BRANCH CIRCUIT CONDUCTOR SIZE SHALL BE #12 AWG. MINIMUM CONTROL CIRCUIT CONDUCTOR SIZE SHALL BE #18 AWG.
  - CONTROL CIRCUITS SHALL BE COPPER, STRANDED CONDUCTOR, 600V INSULATION, THHN/THWN, MINIMUM SIZE 18 AWG.
  - MC CABLE USED FOR FIRE ALARM WIRING SHALL BE COLORED RED AND LISTED FOR FIRE ALARM USE.
- C. INSTALLATION:
- COLOR CODE WIRES BY LINE OR PHASE. COLOR CODE THE 120/208V CONDUCTORS BLACK, RED, BLUE, AND WHITE.
  - DO NOT SHARE NEUTRAL CONDUCTORS. PROVIDE A DEDICATED NEUTRAL CONDUCTOR FOR EACH BRANCH CIRCUIT THAT REQUIRES A NEUTRAL.
  - USE PROPERLY SIZED INSULATED SPRING WIRE CONNECTORS WITH PLASTIC CAPS FOR ALL CONDUCTORS #8 AWG AND SMALLER.
  - INSTALLATION SCHEDULE: BUILDING WIRE IN RACEWAYS AT ALL LOCATIONS UNLESS OTHERWISE NOTED.
  - AT THE CONTRACTOR'S OPTION, PORTIONS OF THE FIRE ALARM WIRING IN DRY, CONCEALED LOCATIONS MAY BE INSTALLED IN FIRE ALARM METAL CLAD CABLE. POWER-LIMITED FIRE ALARM CABLING MAY BE INSTALLED IN J-HOOKS AND/OR CABLE TRAY IF SEPARATED FROM OTHER SYSTEMS.

## 26.05.33 - RACEWAY AND BOXES FOR ELECTRICAL SYSTEMS

- A. SUBMITTALS: NONE REQUIRED FOR THIS SECTION.
- B. MATERIALS:
- ELECTRICAL METALLIC TUBING CONDUIT (EMT): ANSI C80.3. GALVANIZED TUBING. FITTINGS AND CONDUIT BODIES: ANSI/NEMA FB 1; STEEL OR MALLEABLE IRON, COMPRESSION TYPE OR SET SCREW FITTINGS WITH INSULATED THROAT BUSHINGS. DIE-CAST FITTINGS ARE NOT ACCEPTABLE.
  - FLEXIBLE METAL CONDUIT: FS WW-C-566; STEEL, FULL WALL OR REDUCED WALL THICKNESS. FITTINGS AND CONDUIT BODIES: ANSI/NEMA FB 1; STEEL OR MALLEABLE IRON WITH INSULATED THROAT BUSHINGS. DIE CAST FITTINGS ARE NOT ACCEPTABLE.
  - PROVIDE GALVANIZED OR CADMIUM PLATED, ONE PIECE PRESSED STEEL OUTLET BOXES 4 INCH SQUARE OR OCTAGONAL, 1-1/2 INCHES DEEP MINIMUM SIZE FOR USE IN INTERIOR AREAS.
- C. INSTALLATION:
- INSTALL CONDUIT FOR ALL SYSTEMS UNLESS OTHERWISE NOTED, 1/2 INCH MINIMUM SIZE, EXCEPT CONDUIT FOR SPECIAL SYSTEMS SHALL BE 3/4" MINIMUM.
  - ELECTRICAL METALLIC TUBING MAY BE USED EXPOSED WHEN INSTALLED ON THE CEILING, A MINIMUM OF TEN FEET ABOVE THE FLOOR OR WHERE NOT SUBJECT TO PHYSICAL DAMAGE. EMT MAY ALSO BE USED FOR CONCEALED, DRY, INTERIOR LOCATIONS.
  - INSTALL RACEWAYS PER THE LATEST NECA (NATIONAL ELECTRICAL CONTRACTOR'S ASSOCIATION) STANDARDS.
  - PROVIDE RACEWAYS CONCEALED IN CONSTRUCTION UNLESS SPECIFICALLY NOTED OTHERWISE, OR WHERE INSTALLED AT SURFACE CABINETS AND IN MECHANICAL AND ELECTRICAL EQUIPMENT ROOMS.
  - PAINT ALL EXPOSED CONDUIT IN FINISHED AREAS TO MATCH SURFACE TO WHICH IT IS ATTACHED OR CROSSES. CLEAN GREASY OR DIRTY CONDUIT PRIOR TO PAINTING IN ACCORDANCE WITH PAINT MANUFACTURER'S INSTRUCTIONS.
  - INSTALL RACEWAYS LEVEL AND SQUARE TO A TOLERANCE OF 1/8 INCH PER 10 FEET. ROUTE EXPOSED RACEWAYS AND RACEWAYS ABOVE ACCESSIBLE CEILINGS PARALLEL AND PERPENDICULAR TO WALLS, CEILING, STRUCTURAL MEMBERS AND ADJACENT PIPING.
  - PROVIDE OUTLET BOXES AS SHOWN ON THE DRAWINGS, AND AS REQUIRED FOR SPLICES, TAPS, WIRE PULLING, EQUIPMENT CONNECTIONS, DEVICE INSTALLATION AND CODE COMPLIANCE.
  - INSTALL FITTINGS AND FLEXIBLE METAL CONDUIT TO ACCOMMODATE 3-AXIS MOVEMENTS WHERE RACEWAY CROSSES SEISMIC JOINTS. INSTALL FITTINGS DESIGNED AND LISTED TO ACCOMMODATE EXPANSION AND CONTRACTION WHERE RACEWAY CROSSES CONTROL AND EXPANSION JOINTS.
  - SUPPORT BOXES INDEPENDENTLY OF CONDUIT.

## 26.05.53 - IDENTIFICATION FOR ELECTRICAL SYSTEMS

- A. SUBMITTALS: NONE REQUIRED FOR THIS SECTION.
- B. MATERIALS:
- NAMEPLATES: ENGRAVED THREE-LAYER LAMINATED PLASTIC, WHITE LETTERS ON A BLACK BACKGROUND. NAMEPLATES SHALL BE PROVIDED TO IDENTIFY ALL CONTROL EQUIPMENT AND LOADS SERVED.

- TAPE LABELS: ADHESIVE TAPE LABELS, WITH 3/16 INCH BOLD BLACK LETTERS ON CLEAR BACKGROUND MADE USING DYMO RHINOPRO 5000 OR EQUAL LABEL PRINTER.
  - WIRE AND CABLE MARKERS: CLOTH MARKERS, SPLIT SLEEVE OR TUBING TYPE.
- C. INSTALLATION:
- GEAR: PROVIDE ENGRAVED THREE-LAYER LAMINATED PLASTIC NAMEPLATES WITH WHITE LETTERS ON A BLACK BACKGROUND TO IDENTIFY ALL CONTROL EQUIPMENT AND LOADS SERVED.
  - JUNCTION BOXES: MARK ALL CIRCUIT NUMBERS OF WIRING ON ALL JUNCTION BOXES WITH SHEET STEEL COVERS. MARK WITH INDELIBLE BLACK MARKER. ON EXPOSED JUNCTION BOXES IN PUBLIC AREAS, MARK ON INSIDE OF COVER. MARK ALL FIRE ALARM SYSTEM JUNCTION BOXES WITH SHEET STEEL COVERS WITH "FA." MARK WITH INDELIBLE RED MARKER. MARK ALL OTHER SPECIAL SYSTEM JUNCTION BOXES WITH SHEET STEEL COVERS.
  - WIRE IDENTIFICATION: PROVIDE WIRE MARKERS ON EACH CONDUCTOR IN PANELBOARD GUTTERS, PULL BOXES, OUTLET AND JUNCTION BOXES, AND AT LOAD CONNECTION. MARKERS SHALL BE LOCATED WITHIN ONE INCH OF EACH CABLE END, EXCEPT AT PANELBOARDS, WHERE MARKERS FOR BRANCH CIRCUIT CONDUCTORS SHALL BE VISIBLE WITHOUT REMOVING PANEL DEADFRONT.

## 28.46.00 - FIRE DETECTION AND ALARM

- A. SUMMARY: THIS SECTION INCLUDES CONTRACTOR DESIGNED AND INSTALLED EXTENSION TO EXISTING ADDRESSABLE FIRE ALARM AND SMOKE DETECTION SYSTEM. THIS IS A PERFORMANCE TYPE SPECIFICATION DESCRIBING THE MINIMUM ACCEPTABLE FIRE ALARM SYSTEM. THE CONTRACTOR SHALL DESIGN AND INSTALL THE ADDITION TO THE FIRE ALARM AND SMOKE DETECTION SYSTEM IN ACCORDANCE WITH THE REQUIREMENTS OF NFPA 72 AND ADAG. THE FIRE ALARM DEVICES ON THE DRAWINGS ARE SHOWN IN SUGGESTED LOCATIONS. THE FINAL LOCATIONS OF ALL DEVICES SHALL BE SOLELY DETERMINED BY THE CONTRACTOR AND SHALL BE IN ACCORDANCE WITH NFPA 72 AND ADAG. ALL NEW DEVICES ADDED TO THE EXISTING FIRE ALARM CONTROL PANEL SHALL BE UL LISTED FOR OPERATION ON THE EXISTING PANEL.
- B. SUBMITTALS: SUBMIT PRODUCT DATA AND SHOP DRAWINGS FOR APPROVAL.
- C. MATERIALS:
- MANUFACTURER: EST OR OTHER DEVICES LISTED FOR USE WITH THE EXISTING SYSTEM.
  - CONTROL PANEL: UPGRADE EXISTING CONTROL PANEL AND BATTERIES AS REQUIRED TO ACCOMMODATE THE NEW DEVICES ADDED. PROVIDE ALL PROGRAMMING AND TESTING AS REQUIRED. EXISTING FIRE ALARM CONTROL PANEL IS EDWARDS EST 4.
  - FIRE ALARM STROBE LIGHTS: NFPA 72 COMPLIANT, FLUSH WALL OR CEILING MOUNTED, SELF-SYNCHRONIZING, XENON, FIRE ALARM STROBE LAMP AND FLASHER WITH FLASHRATE OF ONE FLASH PER SECOND, COMPLYING WITH THE REQUIREMENTS OF ADAG. PROVIDE RED LETTERED FIRE ON CLEAR LENS. THE STROBE SHALL BE FIELD-SELECTABLE TO PROVIDE 15, 30 75, OR 110 CANDELA SYNCHRONIZED FLASH OUTPUTS.
  - FIRE ALARM HORN: ANSI S3.41 AND NFPA 72 COMPLIANT, SURFACE MOUNTED FIRE ALARM HORN WITH ADJUSTABLE SOUND OUTPUT LEVEL. SOUND RATING: 87 DBA (REVERBERANT) AT 10 FEET ON THE "HIGH" SETTING AND 82 DBA (REVERBERANT) AT 10 FEET ON THE "LOW" SETTING. PROVIDE MINIMUM SOUND PRESSURE LEVEL OF 15 DBA ABOVE THE AVERAGE AMBIENT SOUND LEVEL IN EVERY OCCUPIED SPACE WITHIN THE BUILDING. PROVIDE INTEGRAL FIRE ALARM STROBE LIGHT AS SPECIFIED ABOVE WHERE INDICATED ON THE DRAWINGS.
  - FIRE ALARM SYSTEM POWER BRANCH CIRCUITS: BUILDING WIRE AS SPECIFIED IN SECTION 26 05 19.
  - NOTIFICATION APPLIANCE CIRCUITS: MINIMUM #12 AWG COPPER BUILDING WIRE, AS SPECIFIED IN SECTION 26 05 19.
  - INITIATING AND SIGNALING LINE CIRCUITS: TWISTED, SHIELDED OR UNSHIELDED FIRE ALARM CABLE AS RECOMMENDED BY THE FIRE ALARM SYSTEM MANUFACTURER. MINIMUM SIZE #16 AWG.
  - CABLE SUPPORT: J-HOOKS: CADDY CABLECAT SERIES OR APPROVED EQUAL. SIZE ALL J-HOOKS TO SUPPORT THE QUANTITY OF CABLES INSTALLED, PLUS A MINIMUM OF 25% SPARE CAPACITY.
- D. INSTALLATION:
- THE COMPLETE FIRE ALARM SYSTEM SHALL BE INSTALLED IN ACCORDANCE WITH THE MANUFACTURER'S INSTRUCTIONS.
  - TEST IN ACCORDANCE WITH NFPA 72 AND LOCAL FIRE DEPARTMENT REQUIREMENTS. PROVIDE A COMPLETED NFPA 72 INSPECTION AND TESTING FORM FOR INCLUSION IN THE OPERATION AND MAINTENANCE MANUAL AT THE COMPLETION OF TESTING AND COMMISSIONING THE FIRE ALARM SYSTEM.
  - INSTALL FIRE ALARM WIRING IN A DEDICATED RACEWAY OR CABLING SYSTEM OR AS OTHERWISE NOTED PER SECTION 26 05 33 AND 26 05 19.

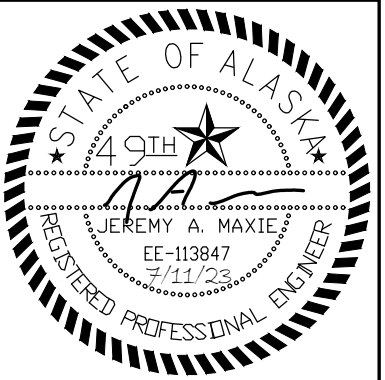

**KPB ARCHITECTS**

500 L STREET, SUITE 400  
ANCHORAGE, AK 99501  
(907) 274-7446 (907) 274-7497  
WWW.KPBARCHITECTS.COM  
AN CORPORATION # 84782 D

**RISA Engineering, Inc.**

MECHANICAL AND ELECTRICAL CONSULTING ENGINEERS  
10000 W. 20th Ave., Anchorage, AK 99515 • (907) 276-0621  
Corporate No. ALECS242

**SOUTHCENTRAL FOUNDATION**

**PCC FIRE ALARM STROBE LIGHT**

**UPGRADES**

**BID DOCUMENTS**

4320 DIPLOMACY DRIVE ANCHORAGE, AK 99508

REVISION SCHEDULE		
#	DESCRIPTION	DATE

JOB NO.	M0256
DATE	07.11.2023
DRAWN	CS2
REVIEWED	JAM, XPT

SHEET NAME  
ELECTRICAL  
SPECIFICATIONS

SHEET NO.  
**E002**



**GENERAL NOTES:**

A. SEE SHEET E001 FOR GENERAL NOTES.

**SHEET NOTES:**

1. NEW DEVICE AT NEW LOCATION. CONNECT TO LOCAL NAC WITH CAPACITY.
2. EXISTING NAC BPS. EXTEND EXISTING CIRCUITS OR PROVIDE TO NEW DEVICES FOR AREA SERVED.
3. PER MOA REVIEW CANDELA ON THIS DEVICE NEEDS TO BE INCREASED TO 110. FIELD ADJUST OR REPLACE DEVICE AS NECESSARY.

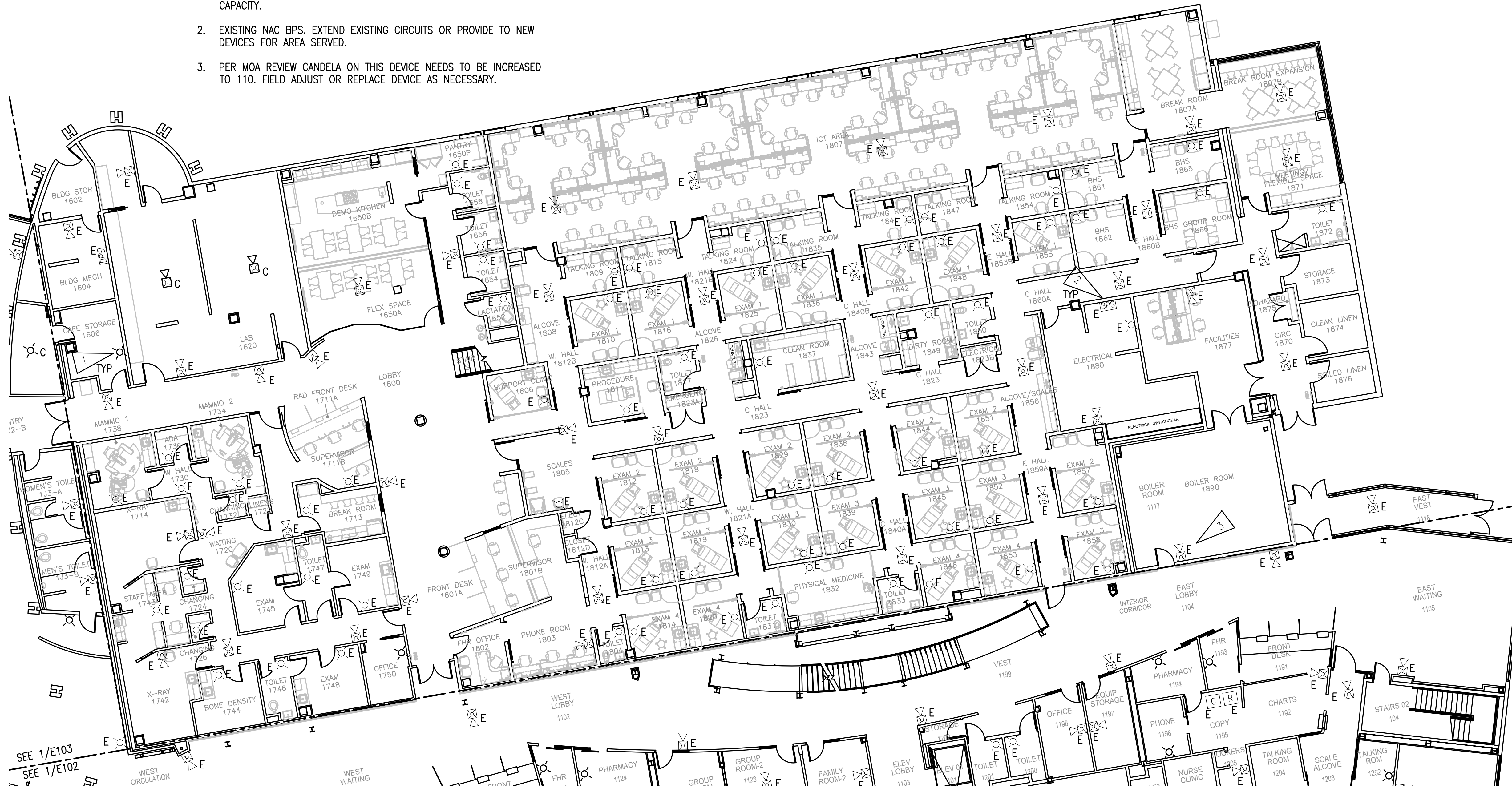

**1 PCCI - FIRST FLOOR FIRE ALARM PLAN**  
3/32" = 1'-0"

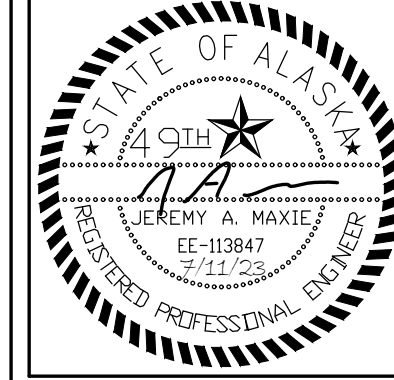
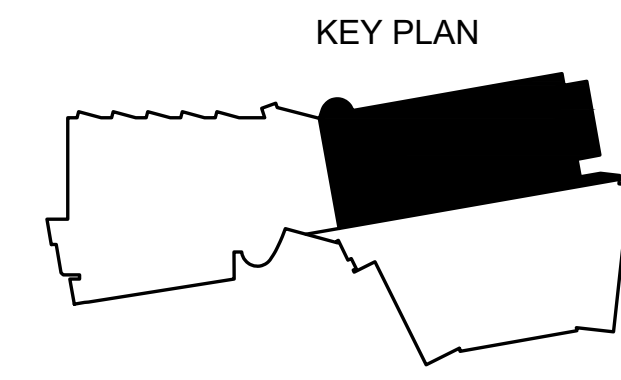

**KPB ARCHITECTS**  
500 L STREET, SUITE 400  
ANCHORAGE, AK 99501  
(907) 274-7448 (907) 274-7497  
WWW.KPBARCHITECTS.COM  
A/C CORPORATION # 54782 D

**RISA Engineering, Inc.**  
MECHANICAL AND ELECTRICAL CONSULTING ENGINEERS  
1000 W. 11TH AVENUE, SUITE 200 - ANCHORAGE, AK 99503 - (907) 276-0271  
CORPORATE NO. AEC0242

**SOUTHCENTRAL FOUNDATION  
PCC FIRE ALARM STROBE LIGHT  
UPGRADES  
BID DOCUMENTS**  
4320 DIPLOMACY DRIVE ANCHORAGE, AK 99508

REVISION SCHEDULE	
#	DESCRIPTION

JOB NO.	M0256
DATE	07.11.2023
DRAWN	CS2
REVIEWED	JAM, XPT

SHEET NAME  
PCCI - FIRST FLOOR FIRE  
ALARM PLAN

SHEET NO.  
**E101**

HALF-SCALE AT 11X17



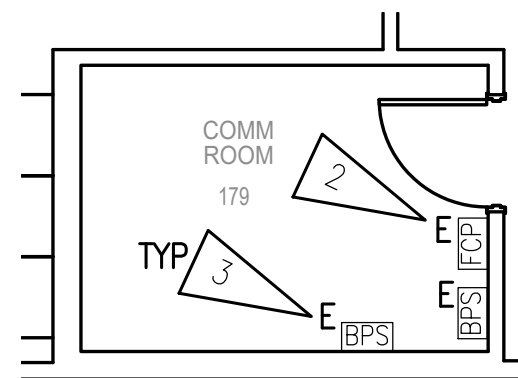

**2 ENLARGED FIRE ALARM PLAN - COMM ROOM 179**  
3/16" = 1'-0"

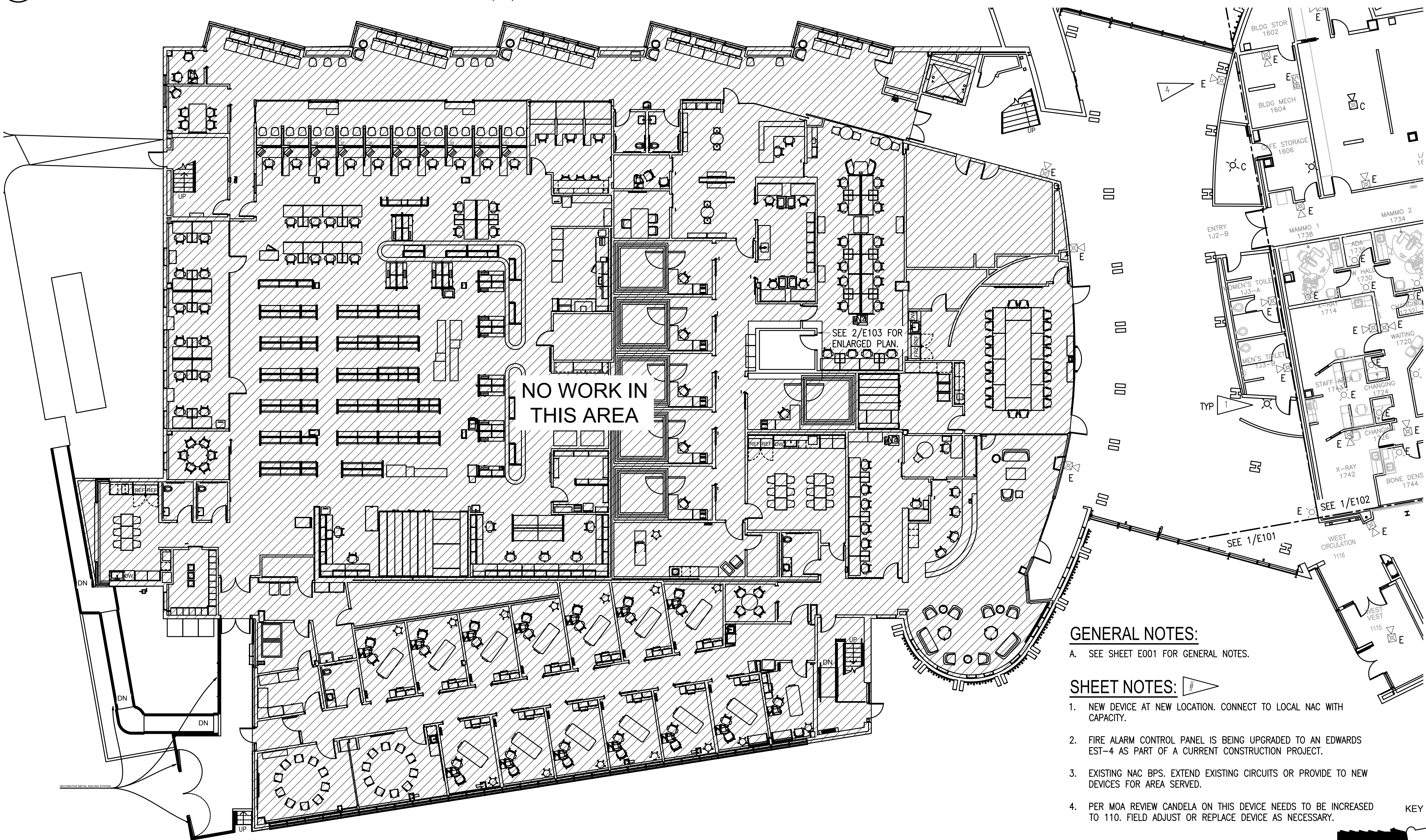

**GENERAL NOTES:**

A. SEE SHEET E001 FOR GENERAL NOTES.

**SHEET NOTES:**

1. NEW DEVICE AT NEW LOCATION. CONNECT TO LOCAL NAC WITH CAPACITY.
2. FIRE ALARM CONTROL PANEL IS BEING UPGRADED TO AN EDWARDS EST-4 AS PART OF A CURRENT CONSTRUCTION PROJECT.
3. EXISTING NAC BPS. EXTEND EXISTING CIRCUITS OR PROVIDE TO NEW DEVICES FOR AREA SERVED.
4. PER MOA REVIEW CANDELA ON THIS DEVICE NEEDS TO BE INCREASED TO 110. FIELD ADJUST OR REPLACE DEVICE AS NECESSARY.

KEY PLAN

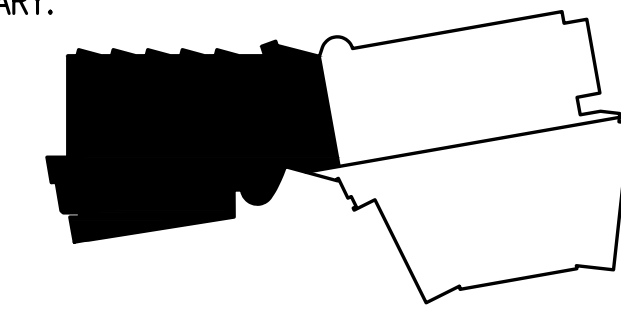

**1 PCCII - FIRST FLOOR - NIC**  
3/32" = 1'-0"



**KPB ARCHITECTS**  
500 L STREET, SUITE 400  
ANCHORAGE, AK 99501  
(907) 274-7448 (907) 274-7497  
WWW.KPBARCHITECTS.COM  
A/C CORPORATION & S/RES D

**RISA Engineering, Inc.**  
MECHANICAL AND ELECTRICAL CONSULTING ENGINEERS  
1000 W. 20th Ave., Anchorage, AK 99503 • (907) 276-0021  
Corporate No. AEC0242

**SOUTHCENTRAL FOUNDATION  
PCC FIRE ALARM STROBE LIGHT  
UPGRADES  
BID DOCUMENTS**  
4320 DIPLOMACY DRIVE ANCHORAGE, AK 99508

REVISION SCHEDULE	
#	DATE

JOB NO.	M0256
DATE	07.11.2023
DRAWN	CS2
REVIEWED	JAM, XPT

SHEET NAME	PCCII - FIRST FLOOR - NIC
------------	---------------------------

SHEET NO.  
**E102**

HALF-SCALE AT 11X17



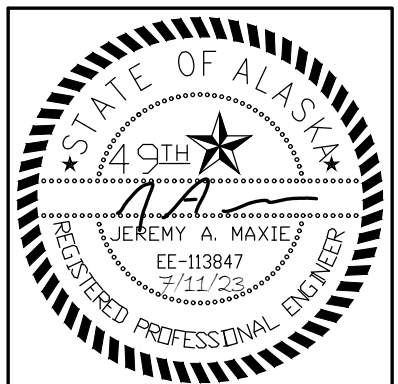

**KPB ARCHITECTS**  
 500 L STREET, SUITE 400  
 ANCHORAGE, AK 99501  
 (907) 274-7448 (907) 274-7497  
 WWW.KPBARCHITECTS.COM  
 AN CORPORATION & S4782 D

**RISA Engineering, Inc.**  
 MECHANICAL AND ELECTRICAL CONSULTING ENGINEERS  
 1000 W. 20th Avenue, Anchorage, AK 99503 - (907) 276-0021  
 Corporate No. AEC0242

**SOUTHCENTRAL FOUNDATION  
 PCC FIRE ALARM STROBE LIGHT  
 UPGRADES  
 BID DOCUMENTS**  
 4320 DIPLOMACY DRIVE ANCHORAGE, AK 99508

REVISION SCHEDULE	
#	DESCRIPTION

JOB NO. M0256  
 DATE 07.11.2023  
 DRAWN CS2  
 REVIEWED JAM, XPT

SHEET NAME  
 PCCIII - FIRST FLOOR  
 FIRE ALARM PLAN

SHEET NO.  
**E103**

HALF-SCALE AT 11X17



**GENERAL NOTES:**

A. SEE SHEET E001 FOR GENERAL NOTES.

**SHEET NOTES:**

1. NEW DEVICE AT NEW LOCATION. CONNECT TO LOCAL NAC WITH CAPACITY.
2. EXISTING NAC BPS. EXTEND EXISTING CIRCUITS OR PROVIDE TO NEW DEVICES FOR AREA SERVED.

**1 PCCIII - FIRST FLOOR FIRE ALARM PLAN**  
 3/32" = 1'-0"

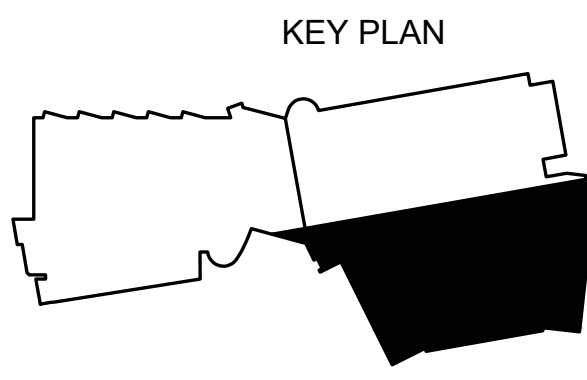
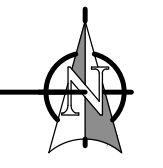



**GENERAL NOTES:**

A. SEE SHEET E001 FOR GENERAL NOTES.

**SHEET NOTES:**

1. NEW DEVICE AT NEW LOCATION. CONNECT TO LOCAL NAC WITH CAPACITY.
2. EXISTING NAC BPS. EXTEND EXISTING CIRCUITS OR PROVIDE TO NEW DEVICES FOR AREA SERVED.
3. HVAC DUCT, NO OCCUPIABLE SPACE.
4. PER MOA REVIEW CANDELA ON THIS DEVICE NEEDS TO BE INCREASED TO 75. FIELD ADJUST OR REPLACE DEVICE AS NECESSARY.



**1** PCCI - SECOND FLOOR FIRE ALARM PLAN  
3/32" = 1'-0"

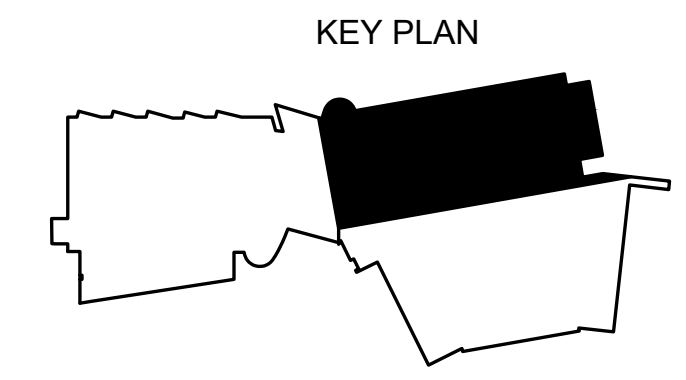

**KPB ARCHITECTS**  
500 L STREET, SUITE 400  
ANCHORAGE, AK 99501  
(907) 274-7448 (907) 274-7497  
WWW.KPBARCHITECTS.COM  
A/C CORPORATION # 54782 D

**RISA Engineering, Inc.**  
MECHANICAL AND ELECTRICAL CONSULTING ENGINEERS  
1000 20th Ave, Anchorage, AK 99503 • (907) 276-0271  
CORPORATE NO. ALEC242

**SOUTHCENTRAL FOUNDATION  
PCC FIRE ALARM STROBE LIGHT  
UPGRADES  
BID DOCUMENTS**  
4320 DIPLOMACY DRIVE ANCHORAGE, AK 99508

REVISION SCHEDULE	
#	DATE

JOB NO. M0256  
DATE 07.11.2023  
DRAWN CS2  
REVIEWED JAM, XPT

SHEET NAME  
PCCI - SECOND FLOOR  
FIRE ALARM PLAN

SHEET NO.  
**E104**



**GENERAL NOTES:**

A. SEE SHEET E001 FOR GENERAL NOTES.

**SHEET NOTES:**

1. NEW DEVICE AT NEW LOCATION. CONNECT TO LOCAL NAC WITH CAPACITY.
2. EXISTING NAC BPS. EXTEND EXISTING CIRCUITS OR PROVIDE TO NEW DEVICES FOR AREA SERVED.

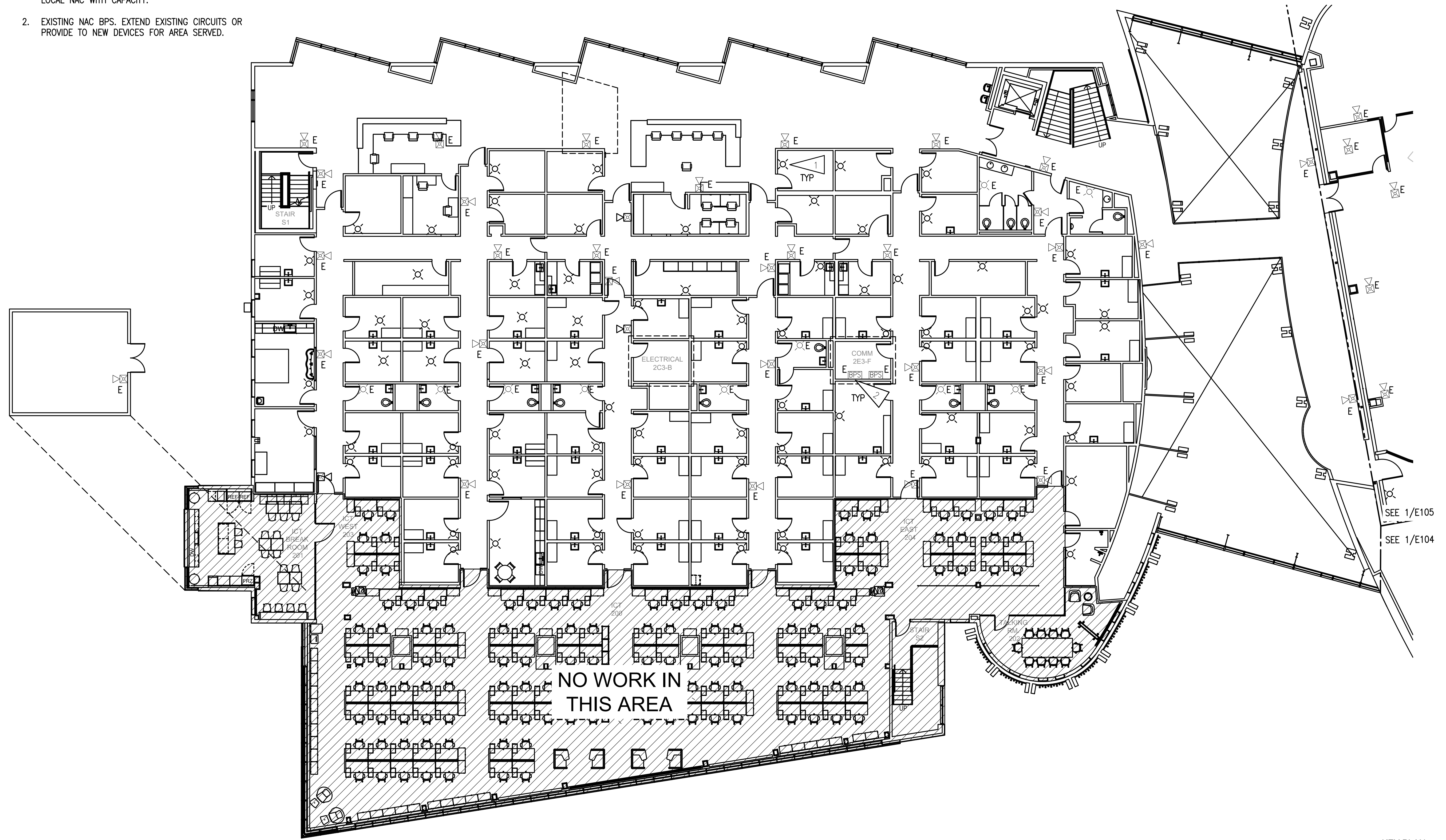

**1** PCCII - SECOND FLOOR - NIC  
3/32" = 1'-0"

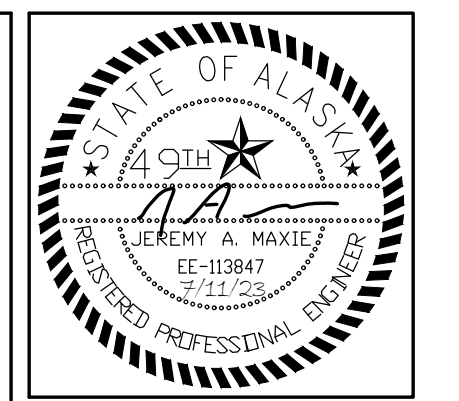
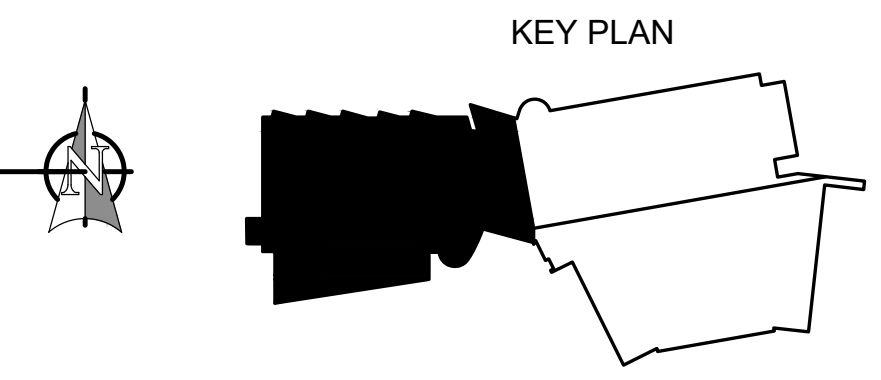

**KPB ARCHITECTS**  
500 L STREET, SUITE 400  
ANCHORAGE, AK 99501  
(907) 274-7448 (P) (907) 274-7407  
WWW.KPBARCHITECTS.COM  
A CORPORATION & S4782 D

**RISA Engineering, Inc.**  
MECHANICAL AND ELECTRICAL CONSULTING ENGINEERS  
1000 20th Ave, Anchorage, AK 99503 - (907) 276-0021  
CORPORATE No. ALEC0242

**SOUTHCENTRAL FOUNDATION  
PCC FIRE ALARM STROBE LIGHT  
UPGRADES  
BID DOCUMENTS**  
4320 DIPLOMACY DRIVE ANCHORAGE, AK 99508

REVISION SCHEDULE	
#	DESCRIPTION

JOB NO. M0256  
DATE 07.11.2023  
DRAWN CS2  
REVIEWED JAM, XPT

SHEET NAME  
PCCII - SECOND FLOOR -  
NIC

SHEET NO.  
**E105**



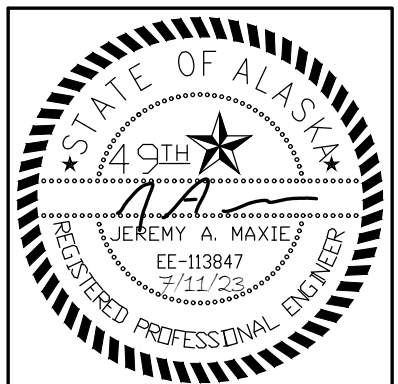

**KPB ARCHITECTS**  
 500 L STREET, SUITE 400  
 ANCHORAGE, AK 99501  
 (907) 274-7448 (907) 274-7497  
 WWW.KPBARCHITECTS.COM  
 AN CORPORATION & S4782 D

**RISA Engineering, Inc.**  
 MECHANICAL AND ELECTRICAL CONSULTING ENGINEERS  
 1000 W. 20th Ave., Anchorage, AK 99503 • (907) 276-0021  
 Corporate No. AEC0242

**SOUTHCENTRAL FOUNDATION  
 PCC FIRE ALARM STROBE LIGHT  
 UPGRADES  
 BID DOCUMENTS**  
 4320 DIPLOMACY DRIVE ANCHORAGE, AK 99508

REVISION SCHEDULE	
#	DESCRIPTION

JOB NO. M0256  
 DATE 07.11.2023  
 DRAWN CS2  
 REVIEWED JAM, XPT

SHEET NAME  
 PCCIII - SECOND FLOOR  
 FIRE ALARM PLAN

SHEET NO.  
**E106**

HALF-SCALE AT 11X17



**GENERAL NOTES:**

- A. SEE SHEET E001 FOR GENERAL NOTES.

**SHEET NOTES:**

1. NEW DEVICE AT NEW LOCATION. CONNECT TO LOCAL NAC WITH CAPACITY.
2. EXISTING NAC BPS. EXTEND EXISTING CIRCUITS OR PROVIDE TO NEW DEVICES FOR AREA SERVED.

**1 PCCIII - SECOND FLOOR FIRE ALARM PLAN**  
 3/32" = 1'-0"

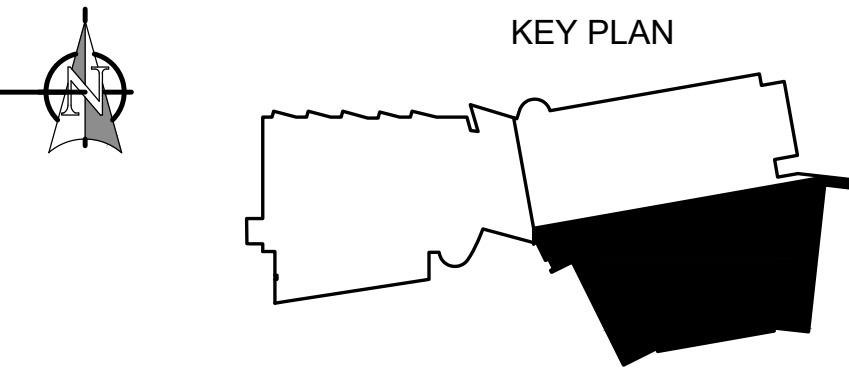

KEY PLAN



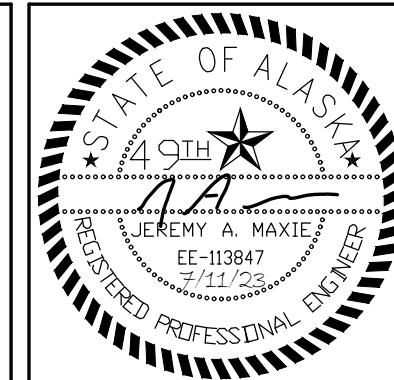

**KPB ARCHITECTS**  
 500 L STREET, SUITE 400  
 ANCHORAGE, AK 99501  
 (907) 274-7448 (907) 274-7497  
 WWW.KPBARCHITECTS.COM  
 AN CORPORATION & S1925 D

**RISA Engineering, Inc.**  
 MECHANICAL AND ELECTRICAL CONSULTING ENGINEERS  
 1000 W. 11TH AVENUE, SUITE 200 - ANCHORAGE, AK 99503 - (907) 276-0021  
 COMPANY NO. AEC0242

**SOUTHCENTRAL FOUNDATION  
 PCC FIRE ALARM STROBE LIGHT  
 UPGRADES  
 BID DOCUMENTS**  
 4320 DIPLOMACY DRIVE ANCHORAGE, AK 99508

REVISION SCHEDULE	
#	DATE

JOB NO. M0256  
 DATE 07.11.2023  
 DRAWN CS2  
 REVIEWED JAM, XPT

SHEET NAME  
 PCCIII - THIRD FLOOR  
 FIRE ALARM PLAN

SHEET NO.  
**E107**

HALF-SCALE AT 11X17



**GENERAL NOTES:**

A. SEE SHEET E001 FOR GENERAL NOTES.

**SHEET NOTES:**

1. NEW DEVICE AT NEW LOCATION. CONNECT TO LOCAL NAC WITH CAPACITY.
2. EXISTING NAC BPS. EXTEND EXISTING CIRCUITS OR PROVIDE TO NEW DEVICES FOR AREA SERVED.
3. WALL-MOUNTED DEVICE TO MATCH EXISTING AND AVOID ARCHITECTURAL CEILING.

**1 PCCIII - THIRD FLOOR FIRE ALARM PLAN**  
 3/32" = 1'-0"

