

Drawing File: \\alderhalder-arch-main\ALDER ARCHITECTURE MAIN\2024 Projects\24036 SCF McGrath Clinic Flooring\Drawings\Revit Files\McGrath Flooring_4-22-25.rvt

Plot Date: 5/1/2025 11:19:44 AM

ARCHITECTURAL ABBREVIATIONS

& @ CL o #	AND CENTERLINE DEGREE NUMBER	FRT FT FTG FURR FUT	FIRE-RETARDENT TREATED FOOT OR FEET FOOTING FURRING FUTURE	R R.D. REF REFR REINF REQ R.H. R.L. RM R.O. R.O.W. RTU	RISER OR RADIUS ROOF DRAIN REFERENCE REFRIGERATOR REINFORCING REQUIRED RIGHT HAND RAIN LEADER ROOM ROUGH OPENING RIGHT OF WAY ROOF TOP UNIT
ABV AC ACP ACT ACOUS ADD AFF AHU ALT ALUM APPROX ARCH ASPH AVG	ABOVE ASPHALTIC CONCRETE ACOUSTICAL CEILING PANEL ACOUSTICAL CEILING TILE ACOUSTICAL ADDITION ABOVE FINISH FLOOR AIR HANDLING UNIT ALTERNATE ALUMINUM APPROXIMATE ARCHITECTURAL ASPHALT AVERAGE	GA GAL GALV G.B. G.I. GL GT GWB GYM GYP.	GAUGE GALLON GALVANIZED GRAB BAR GALVANIZED IRON GLASS GLASS TYPE GYPSUM WALL BOARD GYMNASIUM GYPSUM	S SAN S.C. SCHED S.D. SE SECT SHEATH SHT SIM SND SPEC SQ S.S. S.ST. STD STL STOR STRUCT ST.S SUSP SV SW SYM	SOUTH SANITARY SOLID CORE SCHEDULE SMOKE DETECTOR SOUTHEAST SECTION SHEATHING SHEET SIMILAR SANITARY NAPKIN DISPENSER SPECIFICATIONS SQUARE SANITARY SEWER STAINLESS STEEL STANDARD STEEL STORAGE STRUCTURAL STORM SEWER SUSPENDED SHEET VINYL SOUTHWEST SYMMETRICAL
BD BLDG BLKG BLW BM B.O. BOTH BTU BUR	BOARD BUILDING BLOCKING BELOW BENCH MARK BOTTOM OF BOTH SIDES BRITISH THERMAL UNIT BUILT-UP ROOF	H.B. H.C. HDWD HOWR H.M. H.M.F. HORIZ H.P. HR HT HW HWY	HOSE BIB HOLLOW CORE HARDWOOD HARDWARE HOLLOW METAL HOLLOW METAL FRAME HORIZONTAL HIGH POINT HOUR HEIGHT HOT WATER HIGHWAY	TB TBD TBHM TEL TEMP TERR T&G THRU T.O. T.O.S. TP TV TYP	TACKBOARD TO BE DETERMINED THERMALLY- BROKEN HOLLOW METAL TELEPHONE TEMPORARY TERRAZZO TONGUE AND GROOVE THROUGH TOP OF (eg CONCRETE) TOP OF STEEL TOILET PAPER TELEVISION TYPICAL
CAB C.B. CEM C.I. CIRC CLG CLR. C.M.P. CMU C.O. COL COMP CONC CONSTR CONT COOR CORR C.R. C.R.C. C.T. CTR	CABINET CATCH BASIN CEMENT CAST IRON CIRCULAR CEILING CLEAR CORRUGATED METAL PIPE CONCRETE MASONRY UNIT CARBON MONOXIDE COLUMN COMPOSITION CONCRETE CONSTRUCTION CONTINUOUS COORDINATE CORRIDOR COLD ROLLED COLD ROLLED CHANNEL CERAMIC TILE CENTER	I.D. (") OR IN IHM INSUL INT JAN JT KIT	INSIDE DIAMETER INCHES INSULATED HOLLOW METAL INSULATION INTERIOR JANITOR JOINT KITCHEN	UL UNFIN UNO	UNDERWRITERS LABORATORY UNFINISHED UNLESS NOTED OTHERWISE
DBL DEPT D.F. DET DIA DIAG DIM. DISP DL DN. DS DWG	DOUBLE DEPARTMENT DRINKING FOUNTAIN DETAIL DIAMETER DIAGONAL DIMENSION DISPENSER DEAD LOAD DOWN DOWNSPOUT DRAWINGS	LAB LAM LAV LB LH LL L.O.W. L.P.	LABORATORY LAMINATE OR LAMINATED LAVATORY POUND LEFT HAND LIVE LOAD LIMITS OF WORK LOW POINT	VCT VERT VEST V.I.F VR VTR	VINYL COMPOSITION TILE VERTICAL VESTIBULE VERIFY IN FIELD VAPOR RETARDER VENT THROUGH ROOF
E (E) EA E.I.F.S.	EAST EXISTING EACH EXTERIOR INSULATION & FINISHING SYSTEM	N NE NIC NO NOM NTS NW	NORTH NORTHEAST NOT IN CONTRACT NUMBER NOMINAL NOT TO SCALE NORTHWEST	W W/ WC WD W/O WP WT	WEST WITH WATER CLOSET WOOD WITHOUT WATERPROOF WEIGHT
ELEV ELEV ELEC EMB EQ EQUIP E.G. EXIST EXP EXP.AGG EXP.JT.	ELEVATION ELEVATOR ELECTRICAL EMBOSSING EQUAL EQUIPMENT EACH SIDE EXISTING EXPOSED EXPANSION EXPOSED AGGREGATE EXPANSION JOINT EXTERIOR	PARA PART PERF PERM PERP P.I.C. PL PLAM PLAST PLYWD PR PREFAB PRMA PROJ PT P.T. PTD PVC	PARALLEL PARTITION PERFORATED PERMANENT PERPENDICULAR PRECAST INSULATED CONCRETE PLATE PLASTIC LAMINATE PLASTER PLYWOOD PAIR PREFABRICATED PROTECTED MEMBRANE ROOF ASSEMBLY PROJECT POINT AND PAINT PRESERVATIVE TREATED PAPER TOWEL DISPENSER POLYVINYL CHLORIDE		
F.B. F.D. FDN F.E. F.E.C. FIN FF FF FLUOR F.O.B. F.O.F. F.O.S. F.O. F.R.P. FRPF	FLAT BAR FLOOR DRAIN FOUNDATION FIRE EXTINGUISHER FIRE EXTINGUISHER CABINET FINISH FACTORY FINISH(ED) FINISH FLOOR FLUORESCENT FACE OF BLOCK FACE OF FINISH FACE OF STUD FACE OF (Conc. etc.) FIBER REINFORCED PANEL FIREPROOFING				

ARCHITECTURAL SYMBOLS LEGEND

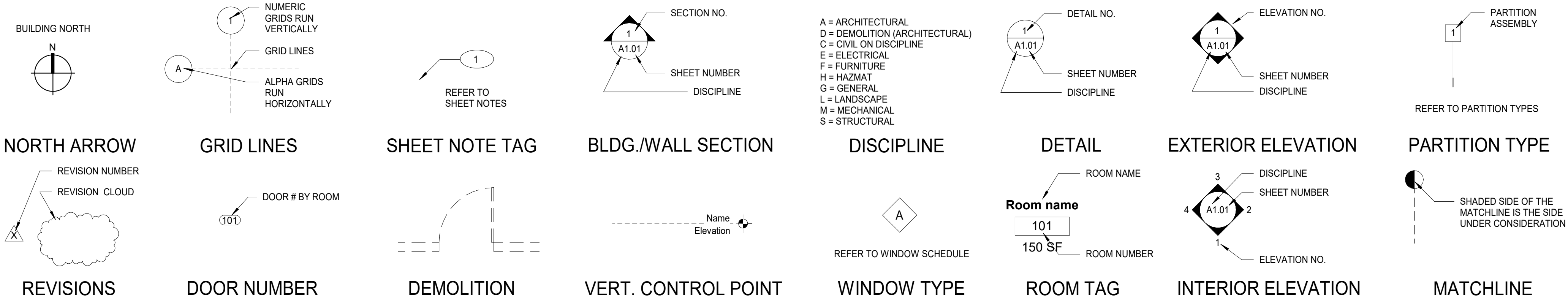

MAP OF ALASKA



DRAWING INDEX

GENERAL

G1.01 COVER SHEET - ABBREVIATIONS, MAP, INDEX, & SYMBOLS LEGEND

ARCHITECTURAL

D1.01 FLOOR FINISH PLAN - DEMOLITION
A1.01 FLOOR FINISH PLAN - RENOVATION
A1.02 DETAILS, FLOORING SPECS, FLOOR FINISH KEYNOTES & FLOOR FINISH SCHEDULE

SCOPE OF WORK

DEMOLITION AND REPLACEMENT OF ALL FLOOR FINISHES AS INDICATED ON THESE CONSTRUCTION DOCUMENTS.

GENERAL CONSTRUCTION NOTES

- THESE DRAWINGS ARE BASED ON THE CURRENT INFORMATION AVAILABLE. FIELD CONDITIONS WHICH DIFFER MATERIALLY FROM THOSE DEPICTED HEREIN SHALL BE BROUGHT TO THE ATTENTION OF THE ARCHITECT PRIOR TO PROCEEDING.
- THESE DRAWINGS ARE INTENDED TO CONVEY A GENERAL SENSE OF REQUIRED WORK, AND DO NOT ADDRESS EVERY FIELD CONDITION. CONTRACTOR SHALL PROVIDE ALL LABOR, MATERIALS AND EQUIPMENT REQUIRED TO PROVIDE A COMPLETE FACILITY.
- CONTRACTOR SHALL COMPLY WITH STATE, LOCAL AND FEDERAL REGULATIONS REGARDING DEMOLITION, HANDLING AND DISPOSAL OF REGULATED MATERIALS. CONTRACTOR SHALL ALSO COMPLY WITH FEDERAL AND STATE OSHA REQUIREMENTS FOR WORKER PROTECTION.
- UPON COMPLETION OF THE WORK, ALL AFFECTED AREAS SHALL BE FINAL CLEANED TO INCLUDE FINISHES, SURFACES, AND FIXTURES.
- OWNER IS RESPONSIBLE FOR REMOVING ALL FURNITURE, OWNER ITEMS, AND MEDICAL EQUIPMENT TO ALLOW THIS FLOORING WORK.
- ALL WORK WILL BE INSTALLED IN ACCORDANCE WITH THE PROVISIONS OF THE 2021 INTERNATIONAL BUILDING CODE, AND ALL OTHER STATE AND LOCAL CODES, INCLUDING ALL AMENDMENTS.
- DO NOT SCALE THE DRAWINGS TO OBTAIN CONSTRUCTION DIMENSIONS.
- ALL INFORMATION SHOULD BE FIELD VERIFIED BEFORE WORK PROCEEDS. ANY DISCREPANCIES FOUND BETWEEN DRAWINGS, DISCIPLINES OR FIELD CONDITIONS, CONTACT THE ARCHITECT IMMEDIATELY.
- ALL DOCUMENTS AND MATERIALS PRODUCED DURING THE PROJECT ARE INSTRUMENTS OF SERVICE. THE ARCHITECT SHALL RETAIN ALL COMMON LAW, STATUTORY AND OTHER RESERVED RIGHTS, INCLUDING COPYRIGHT. THE ARCHITECT SHALL HAVE THE RIGHT TO USE PHOTOGRAPHS OR DRAWING OF THE PROJECT FOR PROMOTIONAL OR OTHER PURPOSES.
- ALL MATERIALS TO BE INSTALLED PER MANUFACTURER REQUIREMENTS AND PROVIDE MAXIMUM WARRANTIES.
- CONTRACTOR RESPONSIBLE FOR REPLACING AND PROVIDING ALL NEW SUBFLOORING, 3/8" ARCHITECTURAL GRADE.

SCF MCGRATH CLINIC FLOORING REPLACEMENT

MCGRATH, ALASKA

REVISIONS		
NO.	DESCRIPTION	DATE

DRAWN BY	DATE
JCH	05-1-2025
CHECKED	JOB NO.
AML	24036

SHEET CONTENTS	
COVER SHEET - ABBREVIATIONS, MAP, INDEX, & SYMBOLS LEGEND	

SHEET NO	
G1.01	

22x34 SHEET IS FULL SCALE
11x17 SHEET IS HALF SCALE



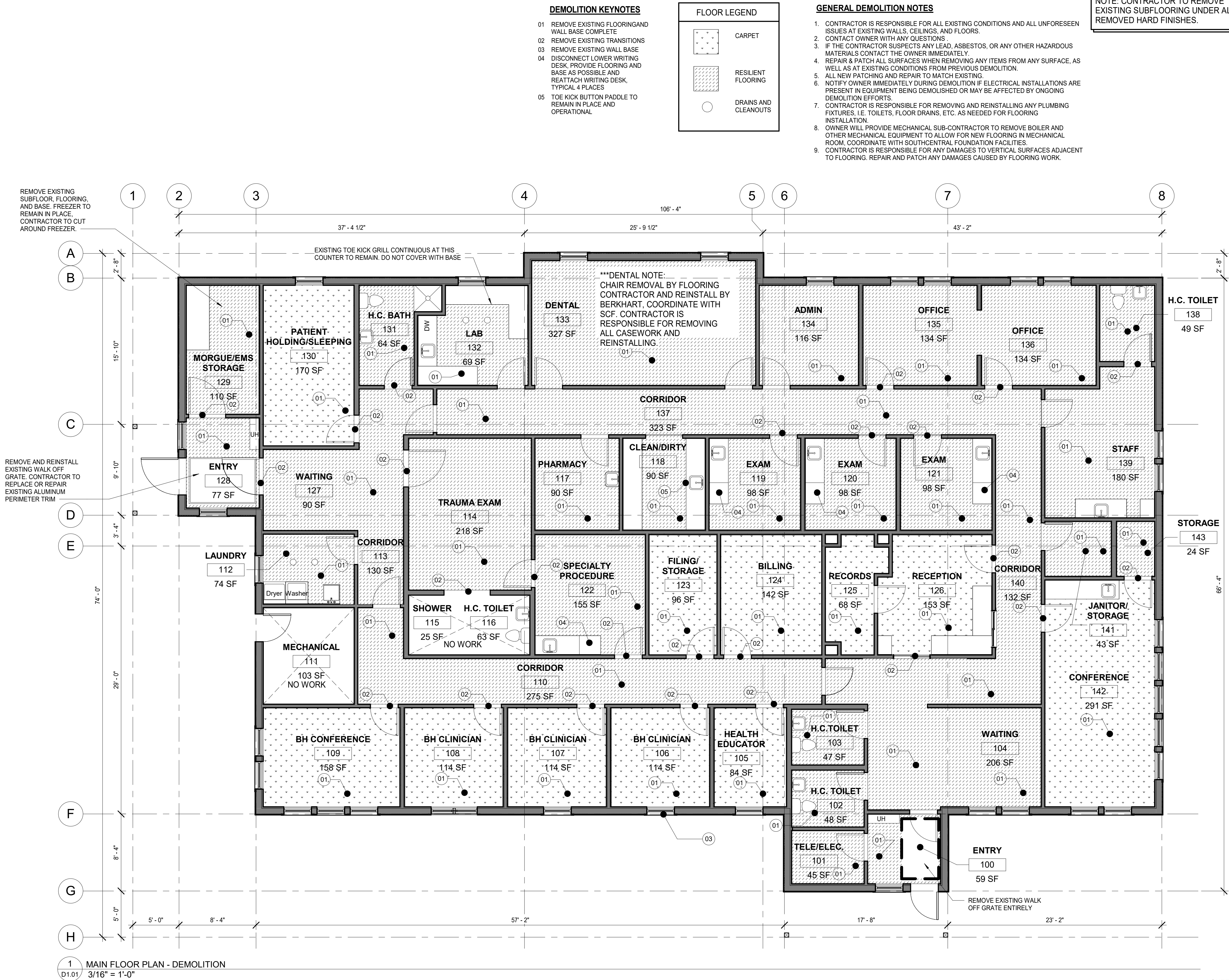

SCF MCGRATH CLINIC FLOORING REPLACEMENT

MCGRATH, ALASKA

REVISIONS		
NO.	DESCRIPTION	DATE

DRAWN BY	DATE
JCH	05-1-2025
CHECKED	JOB NO.
AML	24036

SHEET CONTENTS	
FLOOR FINISH PLAN - DEMOLITION	

SHEET NO	
D1.01	

Drawing File: \\Alder\alder arch main\ALDER ARCHITECTURE MAIN\2024 Projects\24036 SCF McGrath Clinic Flooring\Drawings\Revit Files\McGrath Flooring_4-22-25.rvt

Plot Date: 5/1/2025 11:19:48 AM

GENERAL CONSTRUCTION NOTES

- THESE DRAWINGS ARE BASED ON THE CURRENT INFORMATION AVAILABLE. FIELD CONDITIONS WHICH DIFFER MATERIALLY FROM THOSE DEPICTED HEREIN SHALL BE BROUGHT TO THE ATTENTION OF THE ARCHITECT PRIOR TO PROCEEDING.
- THESE DRAWINGS ARE INTENDED TO CONVEY A GENERAL SENSE OF REQUIRED WORK. AND DO NOT ADDRESS EVERY FIELD CONDITION. CONTRACTOR SHALL PROVIDE ALL LABOR, MATERIALS AND EQUIPMENT REQUIRED TO PROVIDE A COMPLETE FACILITY.
- CONTRACTOR SHALL COMPLY WITH STATE, LOCAL AND FEDERAL REGULATIONS REGARDING DEMOLITION, HANDLING AND DISPOSAL OF REGULATED MATERIALS. CONTRACTOR SHALL ALSO COMPLY WITH FEDERAL AND STATE OSHA REQUIREMENTS FOR WORKER PROTECTION.
- UPON COMPLETION OF THE WORK, ALL AFFECTED AREAS SHALL BE FINAL CLEANED TO INCLUDE FINISHES, SURFACES, AND FIXTURES.
- OWNER IS RESPONSIBLE FOR REMOVING ALL FURNITURE, OWNER ITEMS, AND MEDICAL EQUIPMENT TO ALLOW THIS FLOORING WORK.
- ALL WORK WILL BE INSTALLED IN ACCORDANCE WITH THE PROVISIONS OF THE 2021 INTERNATIONAL BUILDING CODE, AND ALL OTHER STATE AND LOCAL CODES, INCLUDING ALL AMENDMENTS.
- DO NOT SCALE THE DRAWINGS TO OBTAIN CONSTRUCTION DIMENSIONS.
- ALL INFORMATION SHOULD BE FIELD VERIFIED BEFORE WORK PROCEEDS. ANY DISCREPANCIES FOUND BETWEEN DRAWINGS, DISCIPLINES OR FIELD CONDITIONS, CONTACT THE ARCHITECT IMMEDIATELY.
- ALL DOCUMENTS AND MATERIALS PRODUCED DURING THE PROJECT ARE INSTRUMENTS OF SERVICE. THE ARCHITECT SHALL RETAIN ALL COMMON LAW, STATUTORY AND OTHER RESERVED RIGHTS, INCLUDING COPYRIGHT. THE ARCHITECT SHALL HAVE THE RIGHT TO USE PHOTOGRAPHS OR DRAWING OF THE PROJECT FOR PROMOTIONAL OR OTHER PURPOSES.
- ALL MATERIALS TO BE INSTALLED PER MANUFACTURER REQUIREMENTS AND PROVIDE MAXIMUM WARRANTIES.
- CONTRACTOR RESPONSIBLE FOR REPLACING AND PROVIDING ALL NEW SUBFLOORING, 3/8" ARCHITECTURAL GRADE.

CONTRACTOR TO PLACE NEW SUBFLOOR, FLOORING, AND BASE AROUND FREEZER. CONTRACTOR TO PROVIDE ALL MATERIALS FOR OWNER TO COMPLETE ROOM IN THE FUTURE

FLOOR LEGEND

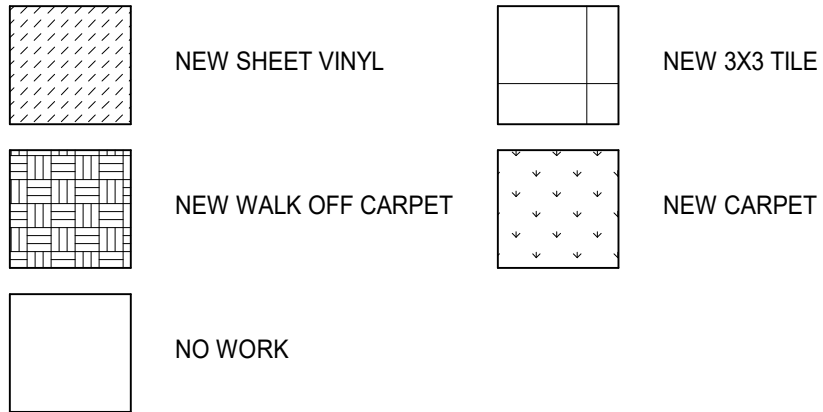

SYMBOLS LEGEND

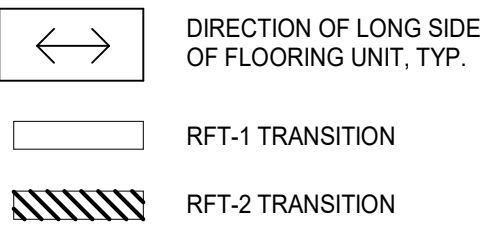

NOTES:

- CONTRACTOR TO PROVIDE NEW 3/8" ARCHITECTURAL GRADE SUBFLOORING UNDER ALL FINAL VINYL FLOORING.
- GLUE AND STAPLE NEW SUBFLOOR AND USE 18 GA, 1/4 CROWN STAPLES TO CONNECT SUBFLOORING TO SHEATHING BELOW.
- IN ROOMS 119, 120, 121, & 122, DISCONNECT THE LOWER WRITING DESK FROM CABINETS, PLACE FLOORING AND BASE AS NEEDED AND REATTACH THE WRITING DESK TO THE CABINETS.

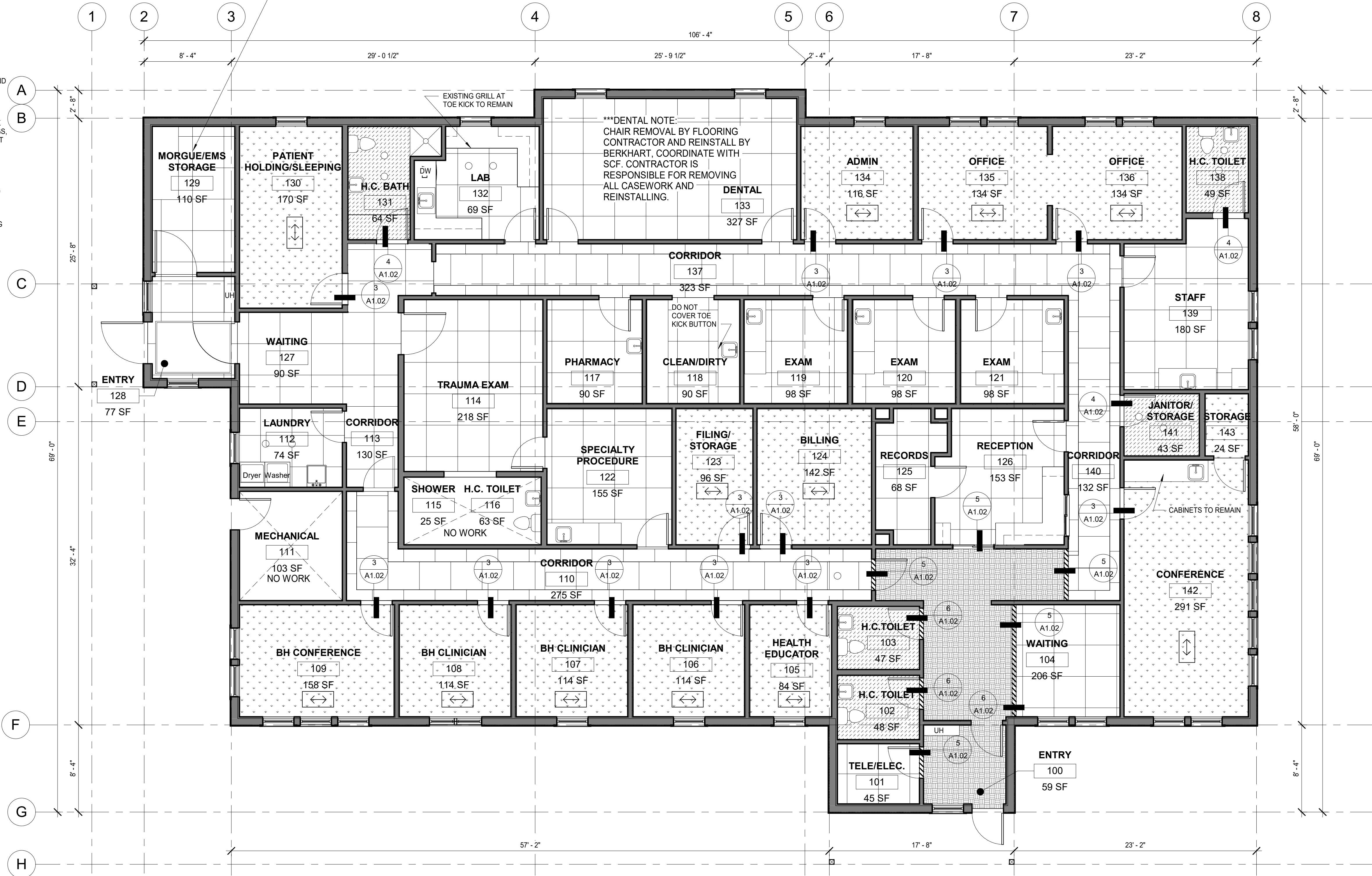

1 MAIN FLOOR PLAN - RENOVATION
A1.01 3/16" = 1'-0"

SCF MCGRATH CLINIC FLOORING REPLACEMENT

MCGRATH, ALASKA

REVISIONS

NO.	DESCRIPTION	DATE

DRAWN BY	DATE
JCH	05-1-2025
CHECKED	JOB NO.
AML	24036

SHEET CONTENTS

FLOOR FINISH PLAN - RENOVATION

SHEET NO

A1.01

22x34 SHEET IS FULL SCALE
11x17 SHEET IS HALF SCALE



Drawing File: \\Alder\alder arch main\ALDER ARCHITECTURE MAIN\2024 Projects\24036 SCF McGrath Clinic Flooring\Drawings\Revit Files\McGrath Flooring_4-22-25.rvt

Plot Date: 5/1/2025 11:19:52 AM

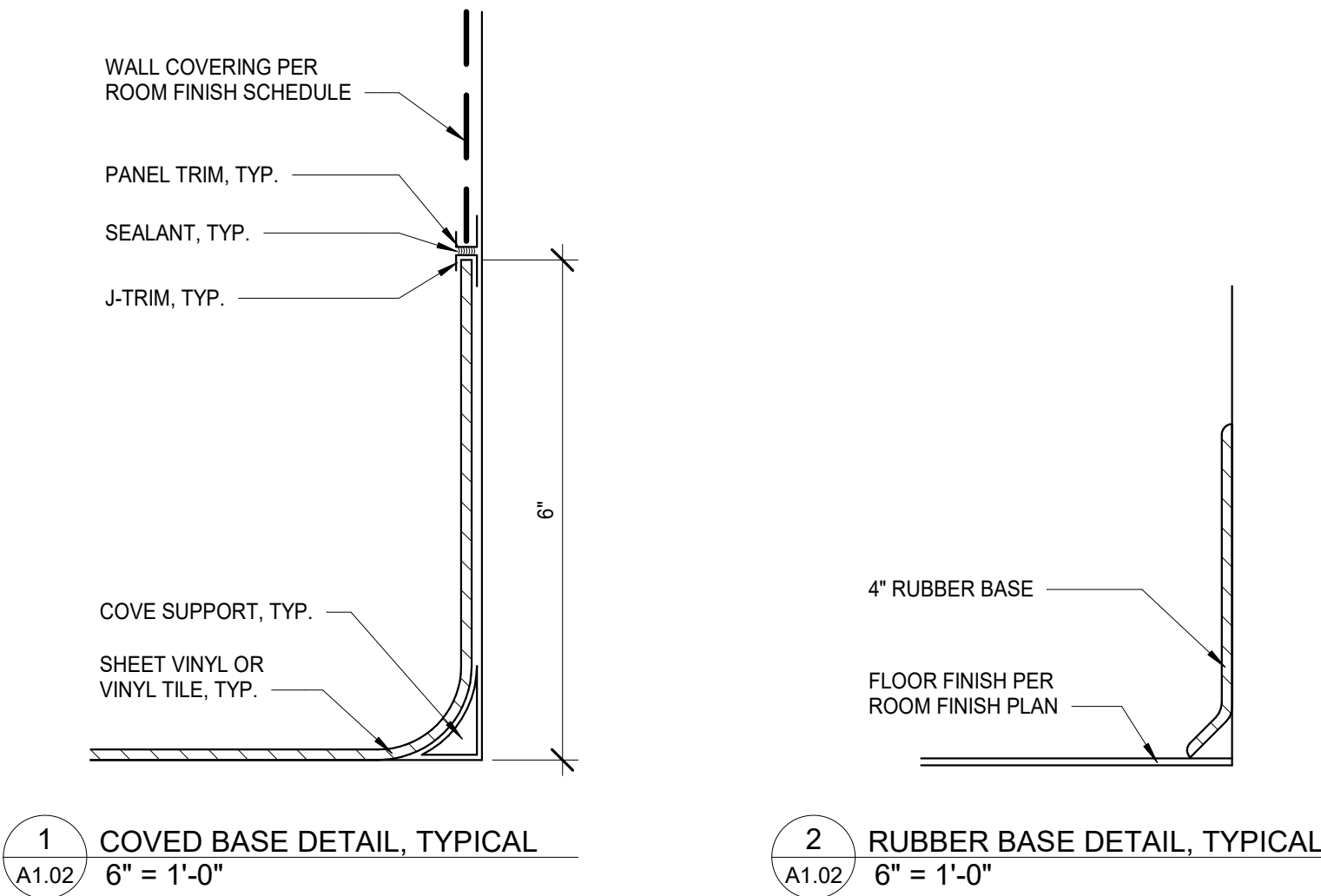

1 COVED BASE DETAIL, TYPICAL
A1.02/ 6" = 1'-0"

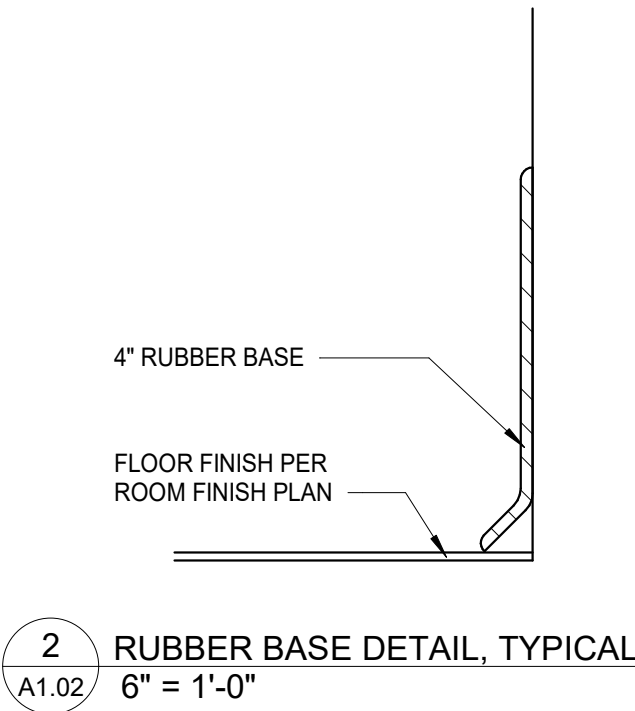

2 RUBBER BASE DETAIL, TYPICAL
A1.02/ 6" = 1'-0"

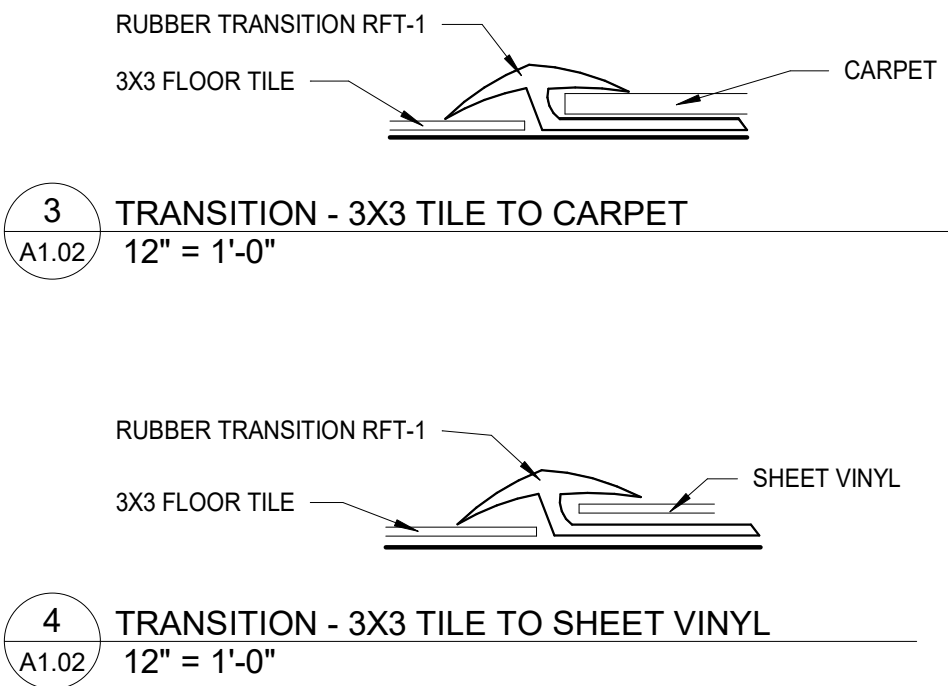

3 TRANSITION - 3X3 TILE TO CARPET
A1.02/ 12" = 1'-0"

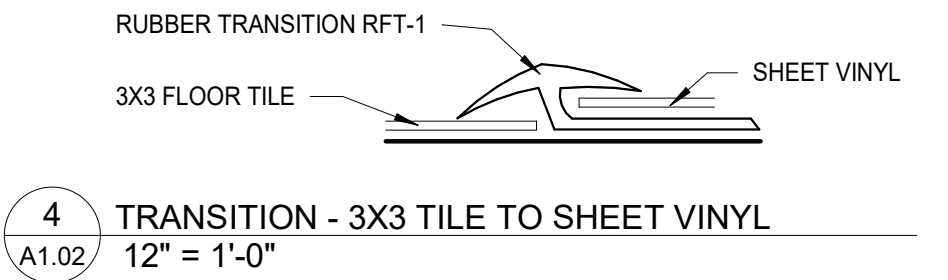

4 TRANSITION - 3X3 TILE TO SHEET VINYL
A1.02/ 12" = 1'-0"

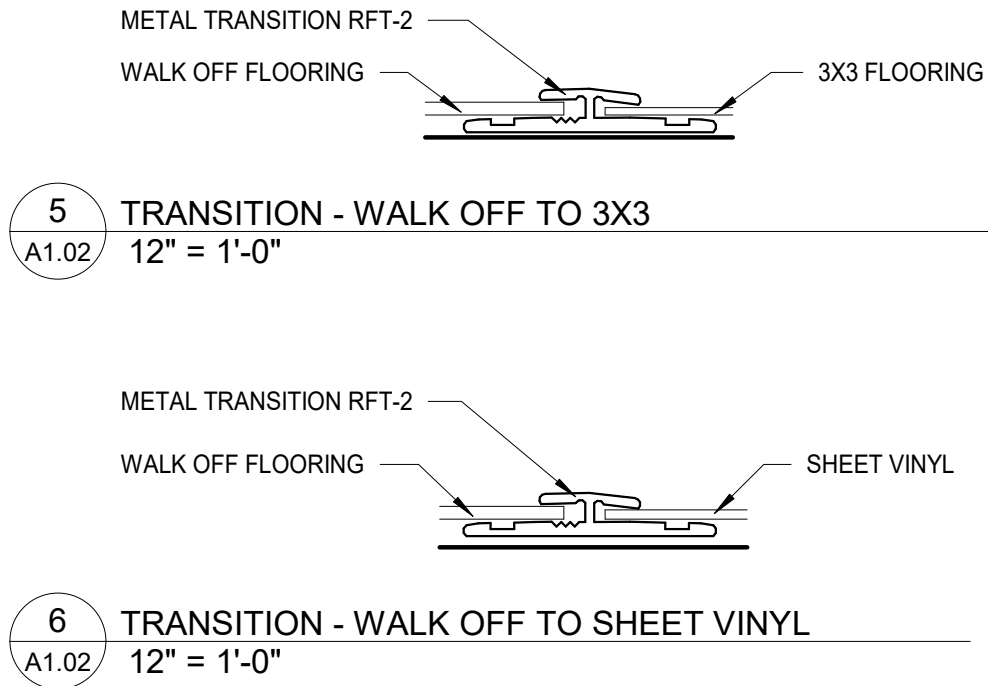

5 TRANSITION - WALK OFF TO 3X3
A1.02/ 12" = 1'-0"

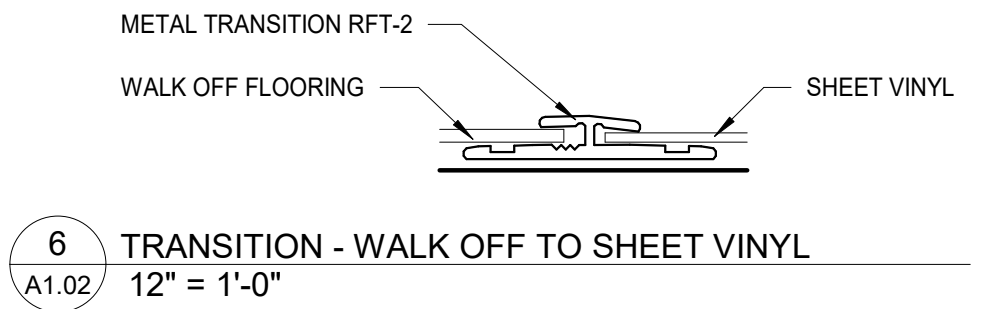

6 TRANSITION - WALK OFF TO SHEET VINYL
A1.02/ 12" = 1'-0"

FLOOR FINISH KEYNOTES	
FLOORING:	
WALK-OFF MAT	
WM-1	SHAW CONTRACT, ALL ACCESS JIVE TILE 5T412,(24 X 24), TROT 12500
RESILIENT SHEET VINYL	
* HEAT WELDED SEAMS, TYP. 6" FLASH COVED BASE WHERE INDICATED.	
ALUMINUM CAP AT COVED BASE UNO.	
SV-1	SHAW CONTRACT, VITALITY WEL 130T, HUMOR 00130
RESILIENT 3X3 VINYL TILE	
VT-1	SHAW CONTRACT, MONTAGE - 4484V,(36 X 36), MIXED 84720
CARPET	
CPT-1	SHAW CONTRACT, FAULT LINES II TILE 5T199, BARK
BASE:	
*ALL WALL BASE TO BE 6" TALL	
RB-1	ROPPE, COLOR: 639 BEIGEWOOD , 700 SERIES (RUBBER BASE)
ICB	INTEGRAL COVE BASE
RESILIENT FLOORING TRANSITIONS & ACCESSORIES	
RFT-1	SHAW CONTRACT, RESILIENT-CARPET REDUCER 1/8", EARTHEN - 0014 (RUBBER)
RFT-2	SHAW CONTRACT, 3.5 MM TMOLD, SATIN SILVER - 143CA (METAL)

NOTE: CONTRACTOR TO PROVIDE NEW 3/8" ARCHITECTUAL GRADE SUBFLOORING UNDER ALL FINAL VINYL FLOORING.

GLUE AND STAPLE SUBFLOOR AND USE 18 GA, 1/4 CROWN STAPLES TO CONNECT SUBFLOORING TO SHEATHING BELOW.

FLOOR FINISH SCHEDULE				
ROOM NUMBER	ROOM NAME	FLOOR FINISH TYPE	BASE FINISH	COMMENTS
100	ENTRY	WM-1	RB-1	
101	TELE/ELEC.	VT-1	RB-1	
102	H.C. TOILET	SV-1	ICB	
103	H.C.TOILET	SV-1	ICB	
104	WAITING	VT-1/WM-1	RB-1	
105	HEALTH EDUCATOR	CPT-1	RB-1	
106	BH CLINICIAN	CPT-1	RB-1	
107	BH CLINICIAN	CPT-1	RB-1	
108	BH CLINICIAN	CPT-1	RB-1	
109	BH CONFERENCE	CPT-1	RB-1	
110	CORRIDOR	VT-1/WM-1	RB-1	
111	MECHANICAL	NO WORK	-	
112	LAUNDRY	VT-1	RB-1	
113	CORRIDOR	VT-1	RB-1	
114	TRAUMA EXAM	VT-1	ICB	
115	SHOWER	NO WORK	-	
116	H.C. TOILET	NO WORK	-	
117	PHARMACY	VT-1	ICB	
118	CLEAN/DIRTY	VT-1	ICB	
119	EXAM	VT-1	ICB	
120	EXAM	VT-1	ICB	
121	EXAM	VT-1	ICB	
122	SPECIALTY PROCEDURE	VT-1	ICB	
123	FILING/ STORAGE	CPT-1	RB-1	
124	BILLING	CPT-1	RB-1	
125	RECORDS	VT-1	RB-1	
126	RECEPTION	VT-1	RB-1	
127	WAITING	VT-1	RB-1	
128	ENTRY	VT-1	RB-1	
129	MORGUE/EMS STORAGE	VT-1	ICB	
130	PATIENT HOLDING/SLEEPING	CPT-1	RB-1	
131	H.C. BATH	SV-1	ICB	
132	LAB	VT-1	ICB	
133	DENTAL	VT-1	ICB	
134	ADMIN	CPT-1	RB-1	
135	OFFICE	CPT-1	RB-1	
136	OFFICE	CPT-1	RB-1	
137	CORRIDOR	VT-1	RB-1	
138	H.C. TOILET	SV-1	ICB	
139	STAFF	VT-1	RB-1	
140	CORRIDOR	VT-1	RB-1	
141	JANITOR/ STORAGE	SV-1	ICB	
142	CONFERENCE	CPT-1	RB-1	
143	STORAGE	CPT-1	RB-1	



7 (E)CORRIDOR 110, TYPICAL
A1.02/ NTS



8 (E) TYP. TOILET RM
A1.02/ NTS



9 (E) ENTRY 128
A1.02/ 1/16" = 1'-0"



10 (E) DENTAL SUITE
A1.02/ 1/4" = 1'-0"



11 (E) DENTAL CABINETS TO BE REMOVED AND REINSTALLED
A1.02/ NTS



12 (E) DENTAL CHAIR (2 TOTAL)
A1.02/ 1/4" = 1'-0"



SCF MCGRATH CLINIC FLOORING REPLACEMENT

MCGRATH, ALASKA

REVISIONS		
NO.	DESCRIPTION	DATE

DRAWN BY	DATE
AML	05-1-2025
CHECKED	JOB NO.
AML	24036

SHEET CONTENTS	
DETAILS, FLOORING SPECS, FLOOR FINISH KEYNOTES & FLOOR FINISH SCHEDULE	

SHEET NO
A1.02

22x34 SHEET IS FULL SCALE
11x17 SHEET IS HALF SCALE

Alder

Architecture & Design, LLC

5060 E Dunbar Dr. Ste C
Wasilla, Alaska 99684
907-357-ALDR(2637)
AlderArchitecture@gmail.com

